



## BUILD-IN VALVES AND SUPPLY STOPS

### 387 Supply stop and washing machine valve



SIZE	PRESSURE	CODE	PACKING
1/2" (DN 15)	8bar/116psi	3870012	1/38

#### CERTIFICATIONS



#### TECHNICAL SPECIFICATIONS

Male thread.

Body in chrome-plated brass.

Cover plate in stainless steel.

Minimum and maximum working temperature: 0°C, 80°C.

Threads: ISO 228 (equivalent to DIN EN ISO 228 and BS EN ISO 228).

#### OVERALL DIMENSIONS

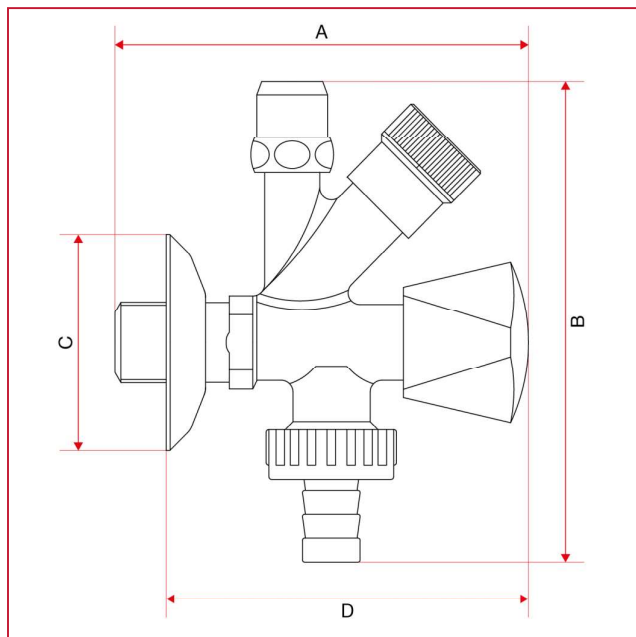



## BUILD-IN VALVES AND SUPPLY STOPS

	1/2"
A	105
B	116
C	56
D	87
Kg/cm <sup>2</sup> bar	8
LBS - psi	116

### MATERIALS

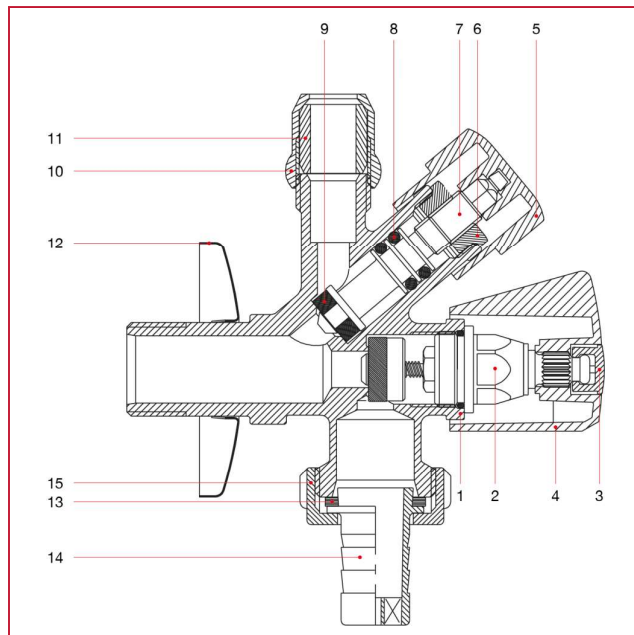

POS.	DESCRIPTION	N.	MATERIAL
1	Body	1	Chrome-plated brass CW617N
2	Bonnet	1	Brass CW614N
3	Cap	1	POM
4	Handle	1	Chrome-plated ABS
5	Handle	1	Chrome-plated ABS
6	Nut	1	Brass CW614N
7	Stem	1	Brass CW614N
8	O-ring	2	NBR
9	Washer	1	NBR
10	Nut	1	Chrome-plated brass CW614N
11	Olive	1	Nylon
12	Cover-plate	1	Stainless steel
13	Washer	1	NBR
14	Hose connection	1	Nylon
15	Nut	1	Nylon