



WASHING MACHINE VALVES

250 Washing machine valve



SIZE	PRESSURE	CODE	PACKING
1/2" (DN 15)	16bar/232psi	2500012	12/84

CERTIFICATIONS



TECHNICAL SPECIFICATIONS

Available size 1/2"x3/4".

Male thread for washing machine.

Body in chrome-plated brass.

Minimum and maximum working temperatures: 0°C, 80°C.

Threads: ISO 228 (equivalent to DIN EN ISO 228 and BS EN ISO 228).

OVERALL DIMENSIONS

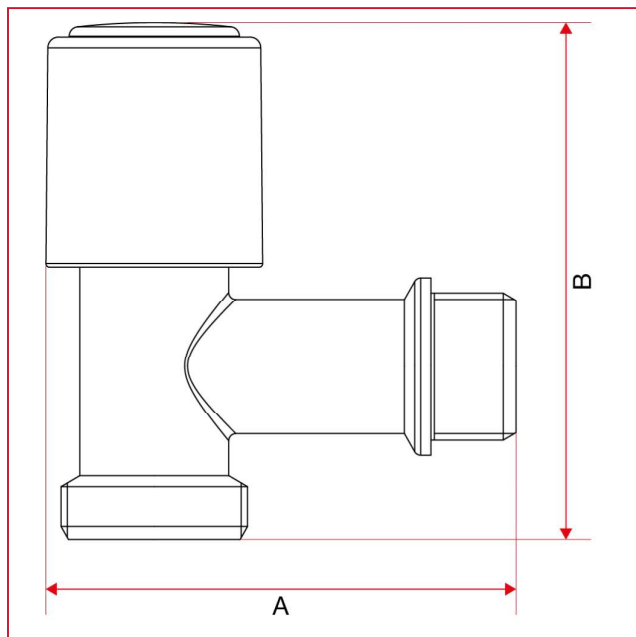

	1/2"
DN	15
A	66,3
B	73
Kg/cm2 bar	16
LBS - psi	232



WASHING MACHINE VALVES

MATERIALS

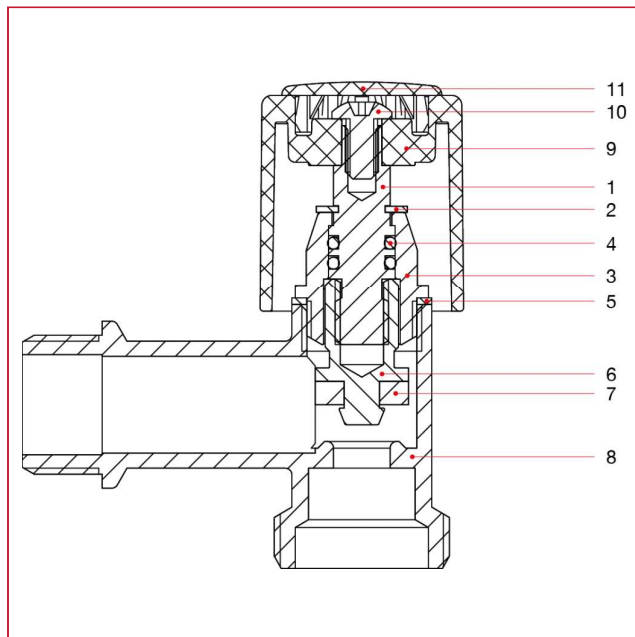

POS.	DESCRIPTION	N.	MATERIAL
1	Pin	1	Brass CW614N
2	Ring	1	Stainless steel AISI 302
3	Cap	1	Brass CW614N
4	O-ring	2	NBR
5	Washer	1	Aluminium
6	Screw	1	Brass CW614N
7	Washer	1	NBR
8	Body	1	Chrome-plated brass CW617N
9	Handle	1	Chrome-plated ABS
10	Screw	1	Zinc-plated steel C4C
11	Clip	1	Varnished ABS