

TECHNICAL CATALOGUE

BIBCOCKS



> THE COMPANY

ITAP SpA, founded in Lumezzane (Brescia) in 1972, is currently one of the leading production companies in Italy of **valves, fittings and distribution manifolds** for plumbing and heating systems.

Thanks to fully automated production processes, with 85 transfer machines and 55 assembly lines, we are able to produce 400,000 pieces per day.

Our innate pursuit for innovation and observance of technical regulations is supported by the company certification ISO 9001. The company has always considered its focus on quality as the main tool to obtain significant business results: today ITAP SpA is proud to offer products bearing the approval of numerous international certifying bodies.



> ITAP products have obtained approvals by more than 30 certification bodies from all over the world.





BIBCOCKS

131 SPIN hose bibcock with mobile connection

Patented - Heavy model.

High resistance against freeze.

SPIN

360° turn. It avoids the garden hose flattening.

Ergonomic handle.

High resistance against freeze.



SIZE	PRESSURE	CODE	PACKING
1/2" (DN 15)	15bar/217.5psi	1310012	10/90

CERTIFICATIONS



TECHNICAL SPECIFICATIONS

Body in nickel-plated brass.

Hose connection in nylon.

Lever handle in aluminium.

Minimum and maximum working temperatures: -20°C, 80°C.

Threads: ISO 228 (equivalent to DIN EN ISO 228 and BS EN ISO 228).



BIBCOCKS

OVERALL DIMENSIONS

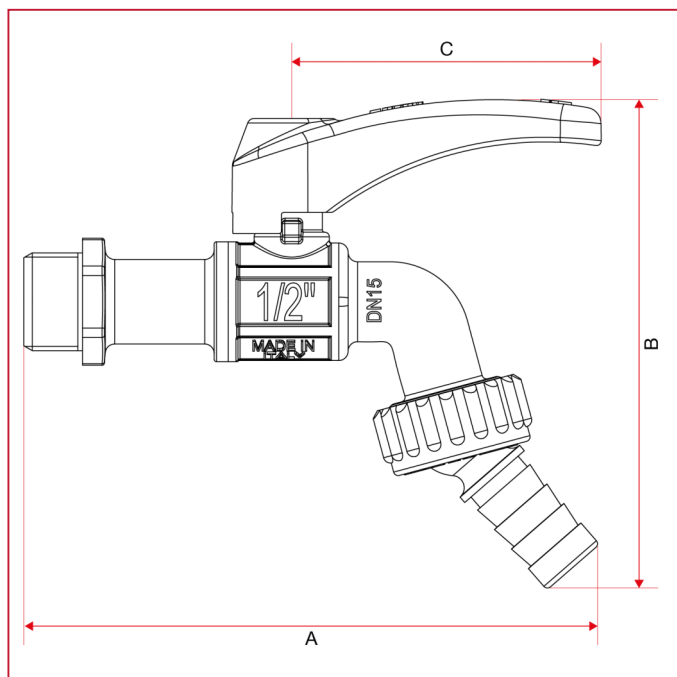

	1/2"
DN	15
A	122
B	103
C	66
Kg/cm2 bar	15
LBS - psi	217,5



MATERIALS

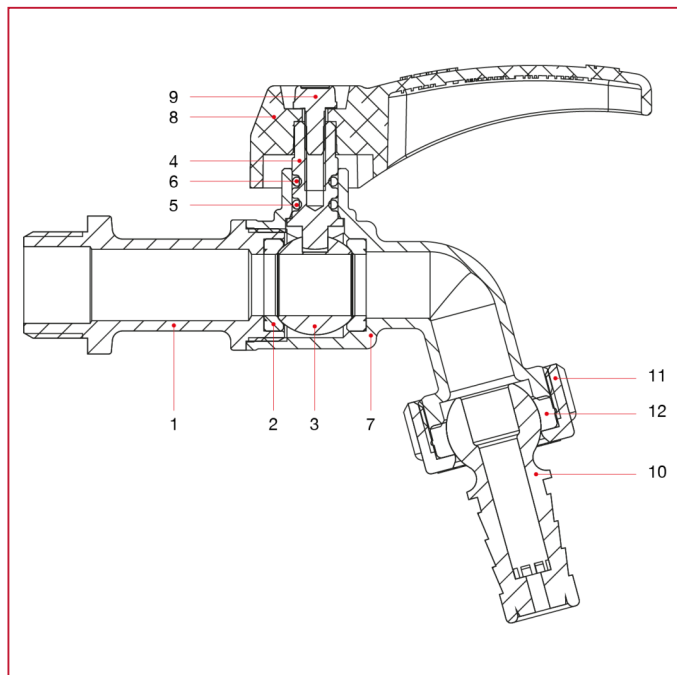

POS.	DESCRIPTION	N.	MATERIAL
1	End adapter	1	Nickel-plated brass CW617N
2	Seat	2	P.T.F.E.
3	Ball	1	Chrome-plated brass CW614N
4	Stem	1	Brass CW614N
5	O-ring	1	NBR
6	O-ring	1	Viton®
7	Body	1	Nickel-plated brass CW617N
8	Lever handle	1	Varnished aluminium
9	Screw	1	Zinc-plated steel C4C
10	Hose connection	1	Nylon
11	Nut	1	Nylon
12	Washer	1	NBR



BIBCOCKS

132 Ball hose bibcock

Available sizes: 3/8"x3/4", 1/2"x3/4", 3/4"x1", 1"x1"1/4



SIZE	PRESSURE	CODE	PACKING
3/8" (DN 10)	15bar/217.5psi	1320038	10/120
1/2" (DN 15)	15bar/217.5psi	1320012	10/120
3/4" (DN 20)	15bar/217.5psi	1320034	6/72
1" (DN 25)	12bar/174psi	1320100	6/42

CERTIFICATIONS



TECHNICAL SPECIFICATIONS

Body in nickel-plated brass.

Hose connection in brass.

Lever handle in steel or flat lever handle in lined steel or T handle in aluminium.

Minimum and maximum working temperatures: -20°C, 80°C.

Threads: ISO 228 (equivalent to DIN EN ISO 228 and BS EN ISO 228).



BIBCOCKS

OVERALL DIMENSIONS

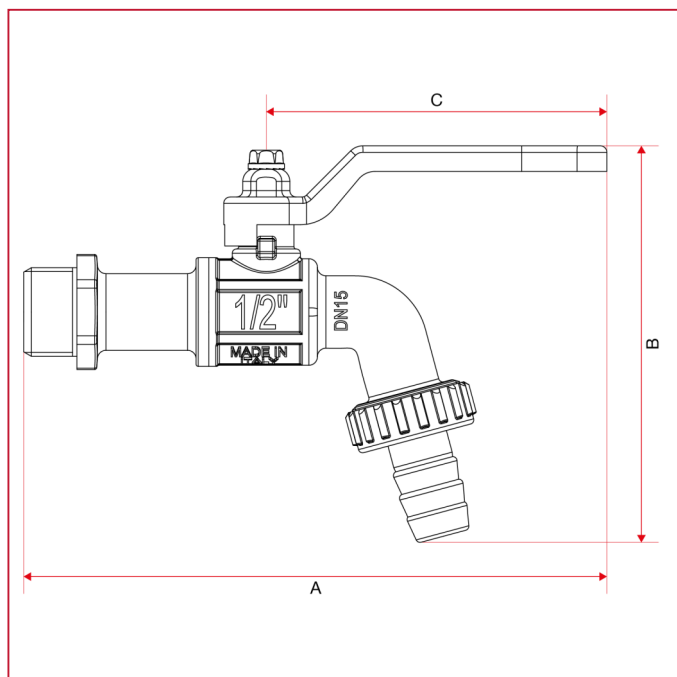

	3/8"	1/2"	3/4"	1"
DN	10	15	20	25
A	135	137	148,5	158
B	93	93	108,5	126
C	80	80	88,5	88,5
Kg/cm2 bar	15	15	15	12
LBS - psi	217,5	217,5	217,5	174



MATERIALS

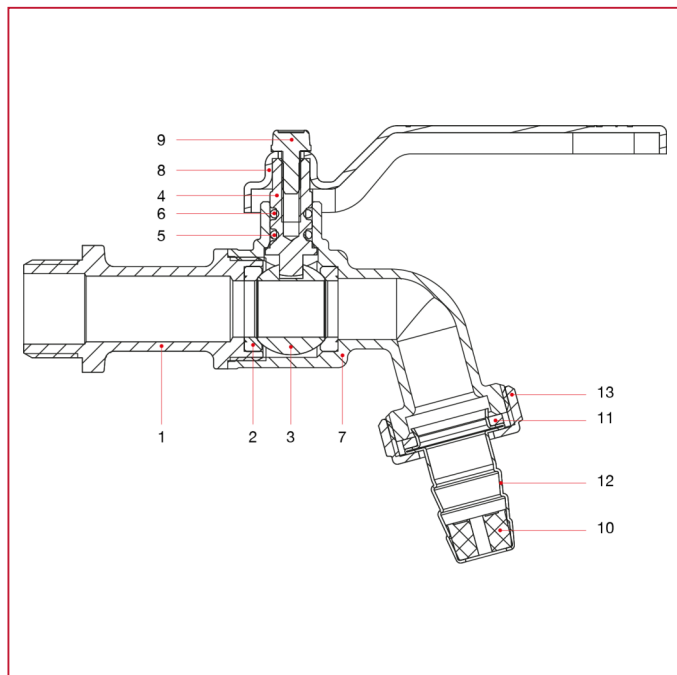

POS.	DESCRIPTION	N.	MATERIAL
1	End adapter	1	Nickel-plated brass CW617N
2	Seat	2	P.T.F.E.
3	Ball	1	Chrome-plated brass CW614N
4	Stem	1	Brass CW614N
5	O-ring	1	NBR
6	O-ring	1	Viton®
7	Body	1	Nickel-plated brass CW617N
8	Lever handle	1	Varnished steel P04
9	Screw	1	Zinc-plated steel C4C
10	Hose end	1	Polymer
11	Washer	1	Elastomer
12	Hose connection	1	Nickel-plated brass CW508L
13	Nut	1	Nickel-plated brass CW617N



BIBCOCKS

133 Ball hose bibcock

Available sizes: 1/2"x3/4", 3/4"x1", 1"x1"1/4



SIZE	PRESSURE	CODE	PACKING
1/2" (DN 15)	15bar/217.5psi	1330012	10/120
3/4" (DN 20)	15bar/217.5psi	1330034	6/72
1" (DN 25)	12bar/174psi	1330100	6/42

CERTIFICATIONS



TECHNICAL SPECIFICATIONS

Body in nickel-plated brass.

Hose connection in brass.

Lever handle in steel or flat lever handle in lined steel or T handle in aluminium.

Minimum and maximum working temperatures: -20°C, 80°C.

Threads: ISO 228 (equivalent to DIN EN ISO 228 and BS EN ISO 228).



BIBCOCKS

OVERALL DIMENSIONS

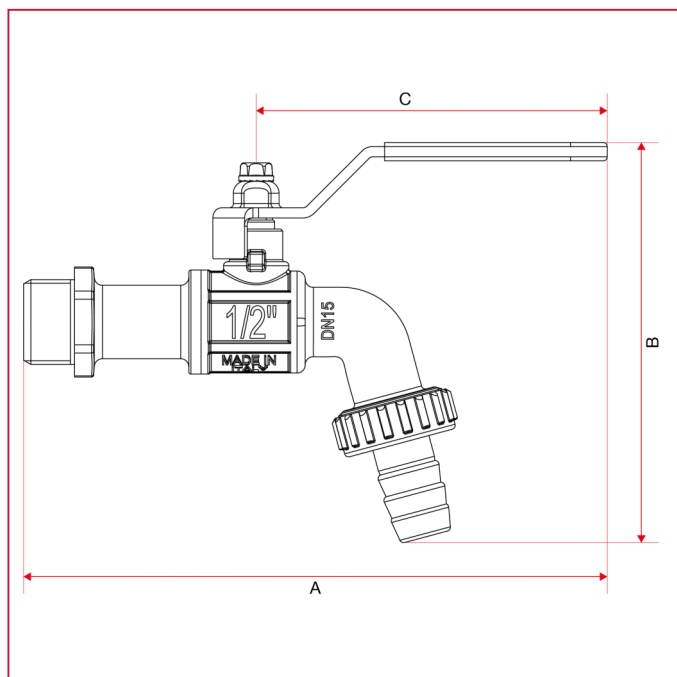

	1/2"	3/4"	1"
DN	15	20	25
A	143	153	162,75
B	98	110,7	128
C	86	93	93
Kg/cm2 bar	15	15	12
LBS - psi	217,5	217,5	174



MATERIALS

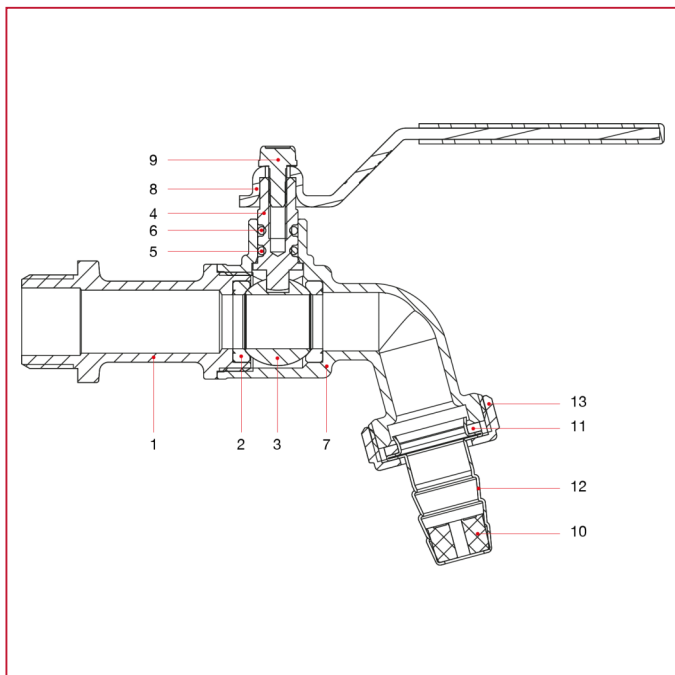

POS.	DESCRIPTION	N.	MATERIAL
1	End adapter	1	Nickel-plated brass CW617N
2	Seat	2	P.T.F.E.
3	Ball	1	Chrome-plated brass CW614N
4	Stem	1	Brass CW614N
5	O-ring	1	NBR
6	O-ring	1	Viton®
7	Body	1	Nickel-plated brass CW617N
8	Flat lever handle	1	Zinc-plated and plastic coated steel P04
9	Screw	1	Zinc-plated steel C4C
10	Hose end	1	Polymer
11	Washer	1	Elastomer
12	Hose connection	1	Nickel-plated brass CW508L
13	Nut	1	Nickel-plated brass CW617N



BIBCOCKS

134 Ball hose bibcock

Available sizes: 3/8"x3/4", 1/2"x3/4", 3/4"x1", 1"x1"1/4



SIZE	PRESSURE	CODE	PACKING
3/8" (DN 10)	15bar/217.5psi	1340038	10/130
1/2" (DN 15)	15bar/217.5psi	1340012	10/130
3/4" (DN 20)	15bar/217.5psi	1340034	6/78
1" (DN 25)	12bar/174psi	1340100	6/42

CERTIFICATIONS



TECHNICAL SPECIFICATIONS

Body in nickel-plated brass.

Hose connection in brass.

Lever handle in steel or flat lever handle in lined steel or T handle in aluminium.

Minimum and maximum working temperatures: -20°C, 80°C.

Threads: ISO 228 (equivalent to DIN EN ISO 228 and BS EN ISO 228).



BIBCOCKS

OVERALL DIMENSIONS

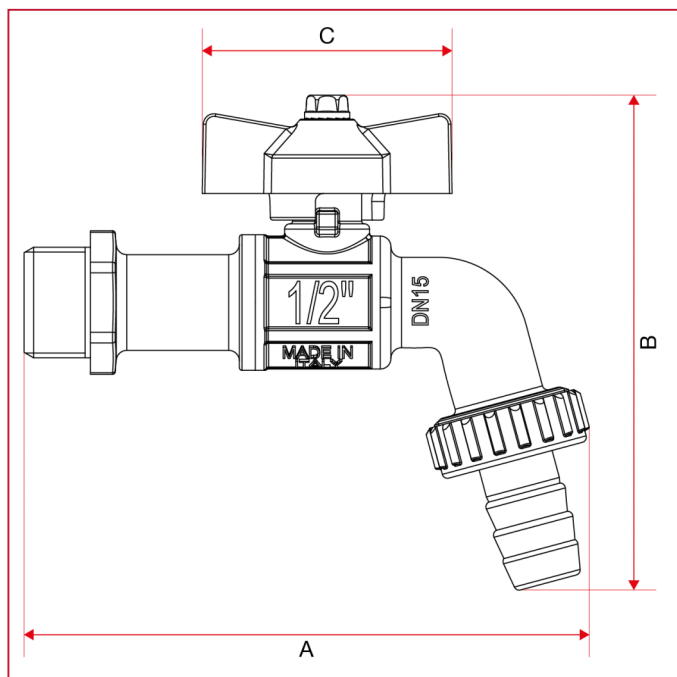

	3/8"	1/2"	3/4"	1"
DN	10	15	20	25
A	104	106	117	138
B	93	93	104	121
C	47	47	54	62
Kg/cm2 bar	15	15	15	12
LBS - psi	217,5	217,5	217,5	174



MATERIALS

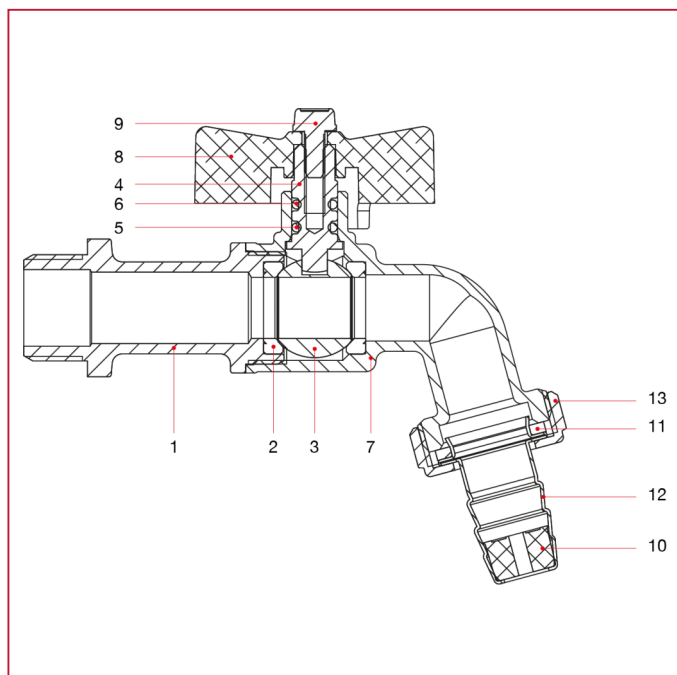

POS.	DESCRIPTION	N.	MATERIAL
1	End adapter	1	Nickel-plated brass CW617N
2	Seat	2	P.T.F.E.
3	Ball	1	Chrome-plated brass CW614N
4	Stem	1	Brass CW614N
5	O-ring	1	NBR
6	O-ring	1	Viton®
7	Body	1	Nickel-plated brass CW617N
8	T handle	1	Varnished aluminium
9	Screw	1	Zinc-plated steel C4C
10	Hose end	1	Polymer
11	Washer	1	Elastomer
12	Hose connection	1	Nickel-plated brass CW508L
13	Nut	1	Nickel-plated brass CW617N



BIBCOCKS

166 GAR ball hose bibcock

Available sizes: 1/2"x3/4", 3/4"x1"



SIZE	PRESSURE	CODE	PACKING
1/2" (DN 15)	15bar/217.5psi	1660012	15/135
3/4" (DN 20)	15bar/217.5psi	1660034	10/90

CERTIFICATIONS



TECHNICAL SPECIFICATIONS

Body in nickel-plated brass.

Hose connection in brass or in nylon.

Lever handle in steel or flat lever handle in lined steel or T handle in aluminium.

Minimum and maximum working temperatures: -20°C, 80°C.

Threads: ISO 228 (equivalent to DIN EN ISO 228 and BS EN ISO 228).



BIBCOCKS

OVERALL DIMENSIONS

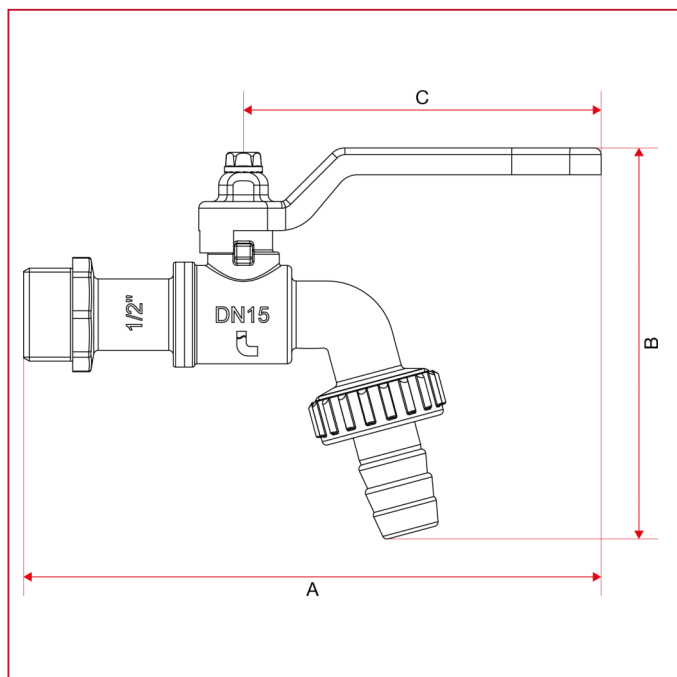

	1/2"	3/4"
DN	15	20
A	129	131,5
B	87,5	97
C	80	80
Kg/cm2 bar	15	15
LBS - psi	217,5	217,5



MATERIALS

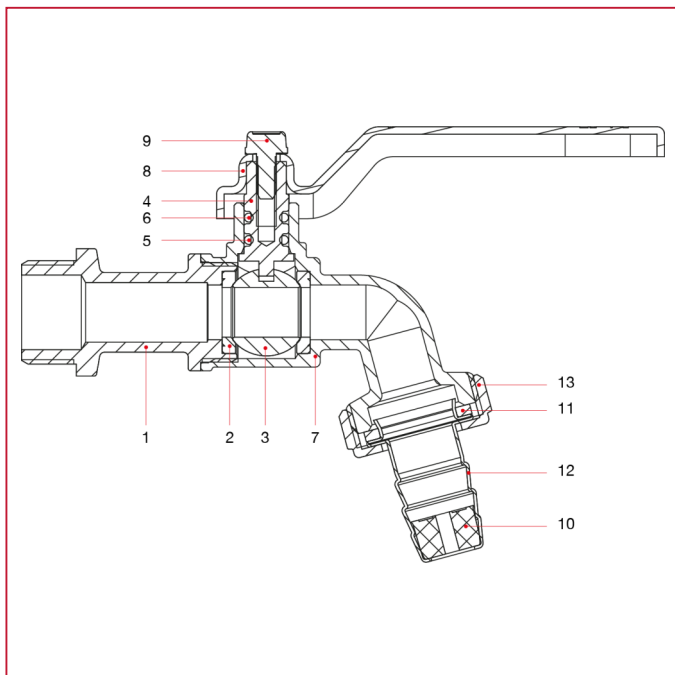

POS.	DESCRIPTION	N.	MATERIAL
1	End adapter	1	Nickel-plated brass CW617N
2	Seat	2	P.T.F.E.
3	Ball	1	Chrome-plated brass CW614N
4	Stem	1	Brass CW614N
5	O-ring	1	NBR
6	O-ring	1	Viton®
7	Body	1	Nickel-plated brass CW617N
8	Lever handle	1	Varnished steel P04
9	Screw	1	Zinc-plated steel C4C
10	Hose end	1	Polymer
11	Washer	1	Elastomer
12	Hose connection	1	Nickel-plated brass CW508L
13	Nut	1	Nickel-plated brass CW617N



BIBCOCKS

167 GAR ball hose bibcock

Available sizes: 1/2"x3/4", 3/4"x1"



SIZE	PRESSURE	CODE	PACKING
1/2" (DN 15)	15bar/217.5psi	1670012	15/105
3/4" (DN 20)	15bar/217.5psi	1670034	10/90

CERTIFICATIONS



TECHNICAL SPECIFICATIONS

Body in nickel-plated brass.

Hose connection in brass or in nylon.

Lever handle in steel or flat lever handle in lined steel or T handle in aluminium.

Minimum and maximum working temperatures: -20°C, 80°C.

Threads: ISO 228 (equivalent to DIN EN ISO 228 and BS EN ISO 228).



BIBCOCKS

OVERALL DIMENSIONS

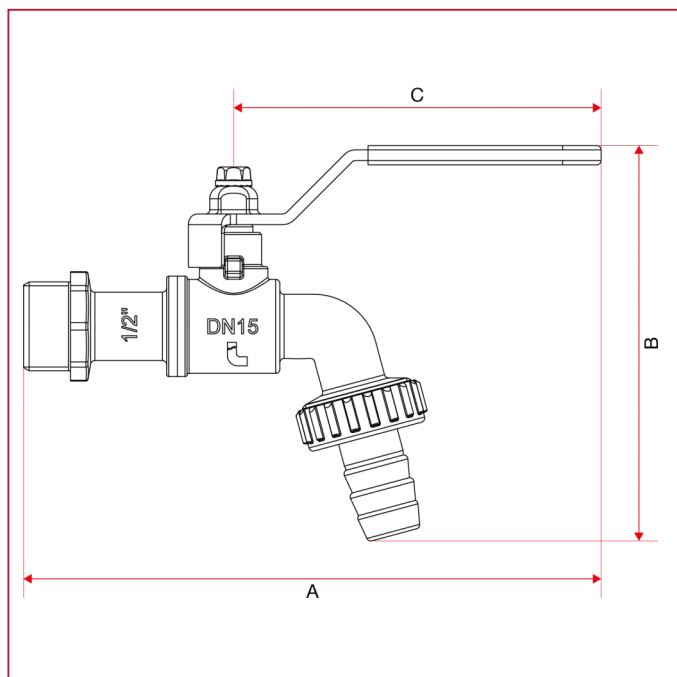

	1/2"	3/4"
DN	15	20
A	135,2	137,5
B	92,5	101,8
C	86	86
Kg/cm ² bar	15	15
LBS - psi	217,5	217,5



MATERIALS

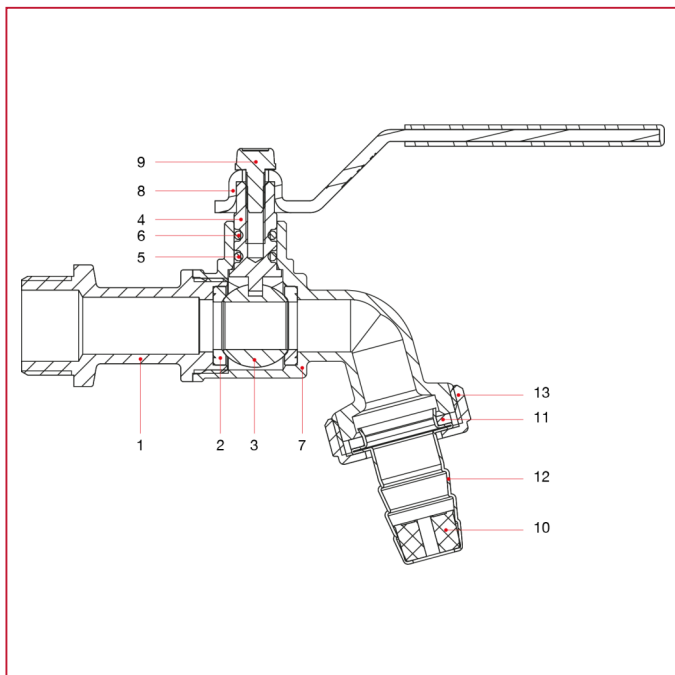

POS.	DESCRIPTION	N.	MATERIAL
1	End adapter	1	Nickel-plated brass CW617N
2	Seat	2	P.T.F.E.
3	Ball	1	Chrome-plated brass CW614N
4	Stem	1	Brass CW614N
5	O-ring	1	NBR
6	O-ring	1	Viton®
7	Body	1	Nickel-plated brass CW617N
8	Flat lever handle	1	Zinc-plated and plastic coated steel P04
9	Screw	1	Zinc-plated steel C4C
10	Hose end	1	Polymer
11	Washer	1	Elastomer
12	Hose connection	1	Nickel-plated brass CW508L
13	Nut	1	Nickel-plated brass CW617N



BIBCOCKS

168 GAR ball hose bibcock

Available sizes: 1/2"x3/4", 3/4"x1"



SIZE	PRESSURE	CODE	PACKING
1/2" (DN 15)	15bar/217.5psi	1680012	15/120
3/4" (DN 20)	15bar/217.5psi	1680034	10/90

CERTIFICATIONS



TECHNICAL SPECIFICATIONS

Body in nickel-plated brass.

Hose connection in brass or in nylon.

Lever handle in steel or flat lever handle in lined steel or T handle in aluminium.

Minimum and maximum working temperatures: -20°C, 80°C.

Threads: ISO 228 (equivalent to DIN EN ISO 228 and BS EN ISO 228).



BIBCOCKS

OVERALL DIMENSIONS

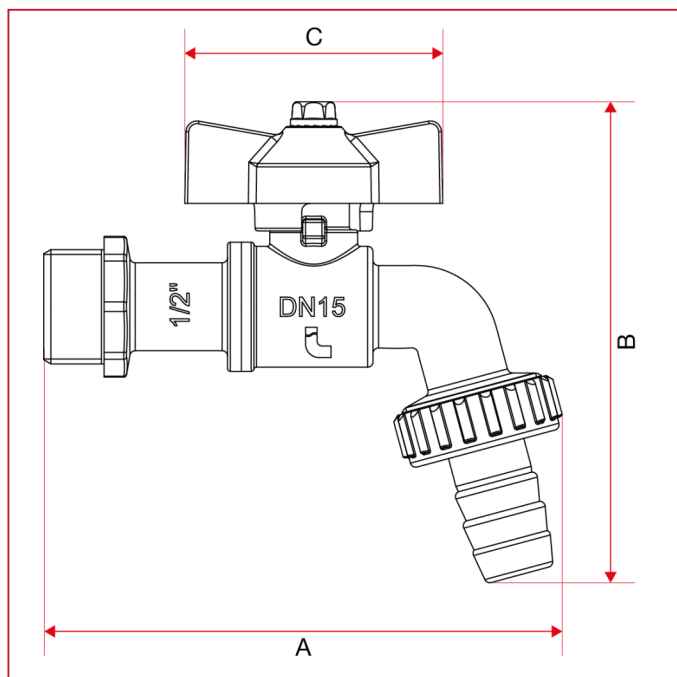

	1/2"	3/4"
DN	15	20
A	94,5	103,5
B	87,5	97
C	47	47
Kg/cm ² bar	15	15
LBS - psi	217,5	217,5



MATERIALS

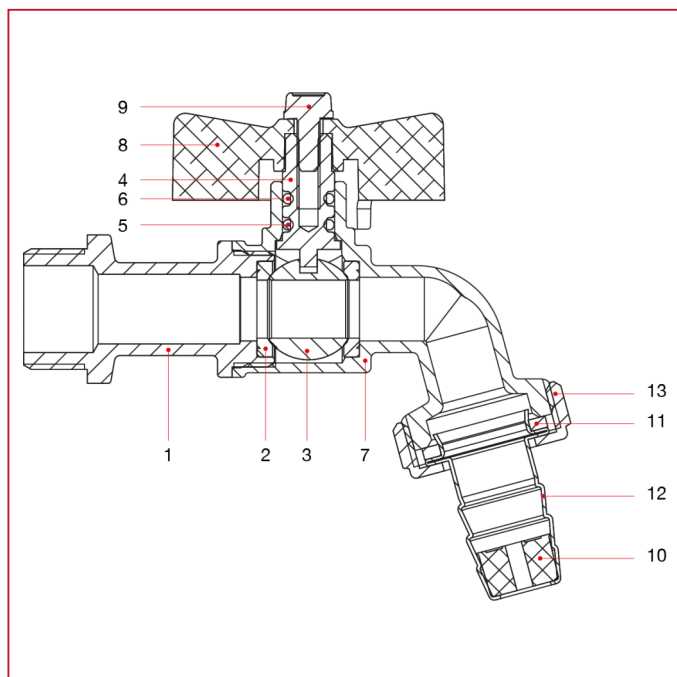

POS.	DESCRIPTION	N.	MATERIAL
1	End adapter	1	Nickel-plated brass CW617N
2	Seat	2	P.T.F.E.
3	Ball	1	Chrome-plated brass CW614N
4	Stem	1	Brass CW614N
5	O-ring	1	NBR
6	O-ring	1	Viton®
7	Body	1	Nickel-plated brass CW617N
8	T handle	1	Varnished aluminium
9	Screw	1	Zinc-plated steel C4C
10	Hose end	1	Polymer
11	Washer	1	Elastomer
12	Hose connection	1	Nickel-plated brass CW508L
13	Nut	1	Nickel-plated brass CW617N



BIBCOCKS

174 GAR ball hose bibcock

Available sizes: 1/2"x3/4", 3/4"x1"



SIZE	PRESSURE	CODE	PACKING
1/2" (DN 15)	15bar/217.5psi	1740012	15/135
3/4" (DN 20)	15bar/217.5psi	1740034	10/90

CERTIFICATIONS



TECHNICAL SPECIFICATIONS

Body in nickel-plated brass.

Hose connection in brass or in nylon.

Lever handle in steel or flat lever handle in lined steel or T handle in aluminium.

Minimum and maximum working temperatures: -20°C, 80°C.

Threads: ISO 228 (equivalent to DIN EN ISO 228 and BS EN ISO 228).



BIBCOCKS

OVERALL DIMENSIONS

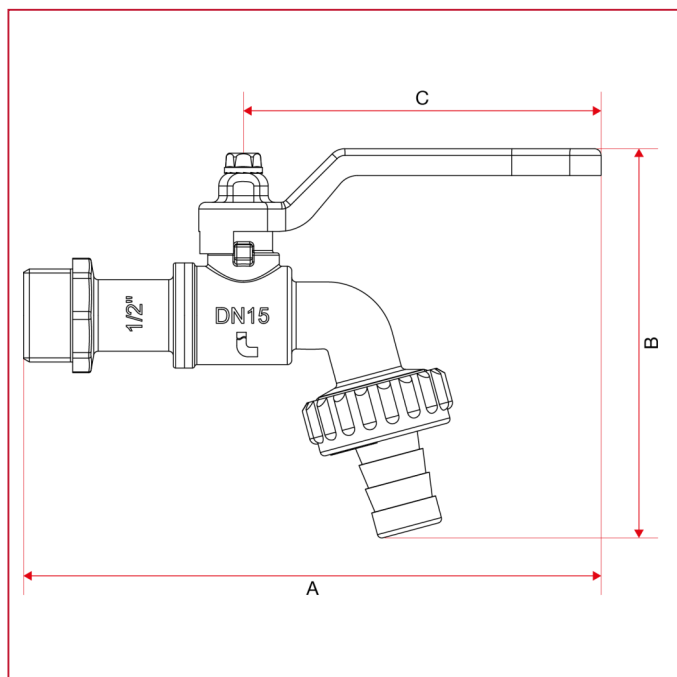

	1/2"	3/4"
DN	15	20
A	129	131,5
B	87	98
C	80	80
Kg/cm2 bar	15	15
LBS - psi	217,5	217,5



MATERIALS

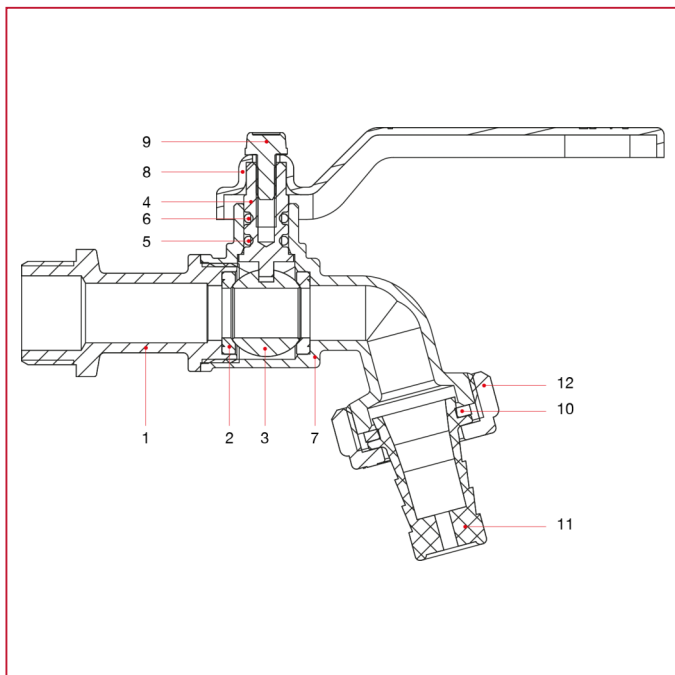

POS.	DESCRIPTION	N.	MATERIAL
1	End adapter	1	Nickel-plated brass CW617N
2	Seat	2	P.T.F.E.
3	Ball	1	Chrome-plated brass CW614N
4	Stem	1	Brass CW614N
5	O-ring	1	NBR
6	O-ring	1	Viton®
7	Body	1	Nickel-plated brass CW617N
8	Lever handle	1	Varnished steel P04
9	Screw	1	Zinc-plated steel C4C
10	Washer	1	NBR
11	Hose connection	1	Polymer
12	Nut	1	Nylon



BIBCOCKS

176 GAR ball hose bibcock

Available sizes: 1/2"x3/4", 3/4"x1"

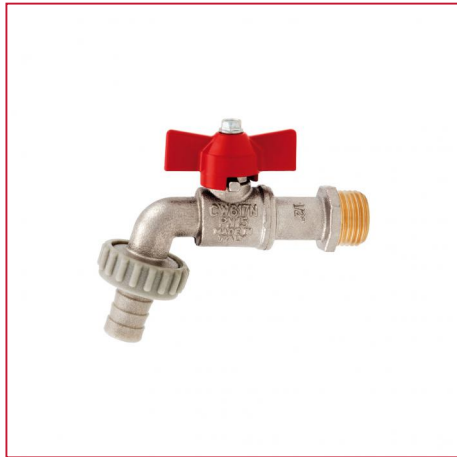

SIZE	PRESSURE	CODE	PACKING
1/2" (DN 15)	15bar/217.5psi	1760012	15/120
3/4" (DN 20)	15bar/217.5psi	1760034	10/90

CERTIFICATIONS



TECHNICAL SPECIFICATIONS

Body in nickel-plated brass.

Hose connection in brass or in nylon.

Lever handle in steel or flat lever handle in lined steel or T handle in aluminium.

Minimum and maximum working temperatures: -20°C, 80°C.

Threads: ISO 228 (equivalent to DIN EN ISO 228 and BS EN ISO 228).



BIBCOCKS

OVERALL DIMENSIONS

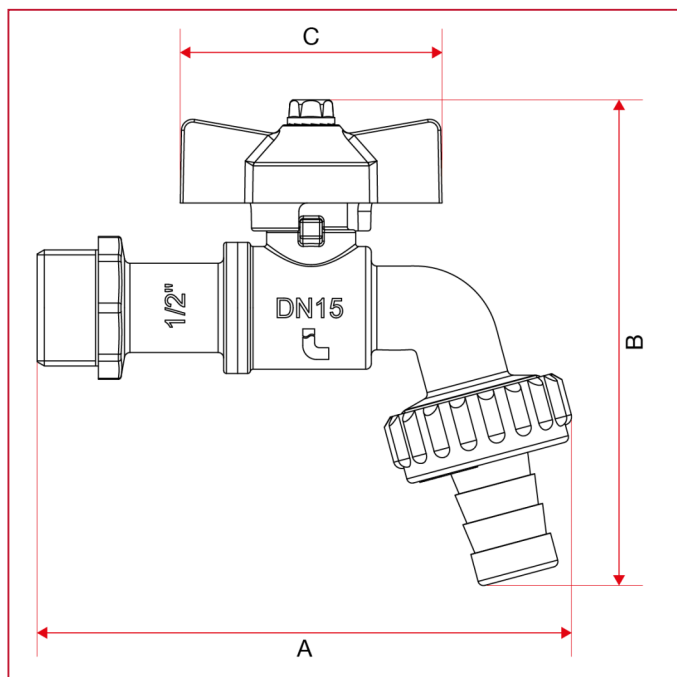

	1/2"	3/4"
DN	15	20
A	96	105,5
B	87	98
C	47	47
Kg/cm2 bar	15	15
LBS - psi	217,5	217,5



MATERIALS

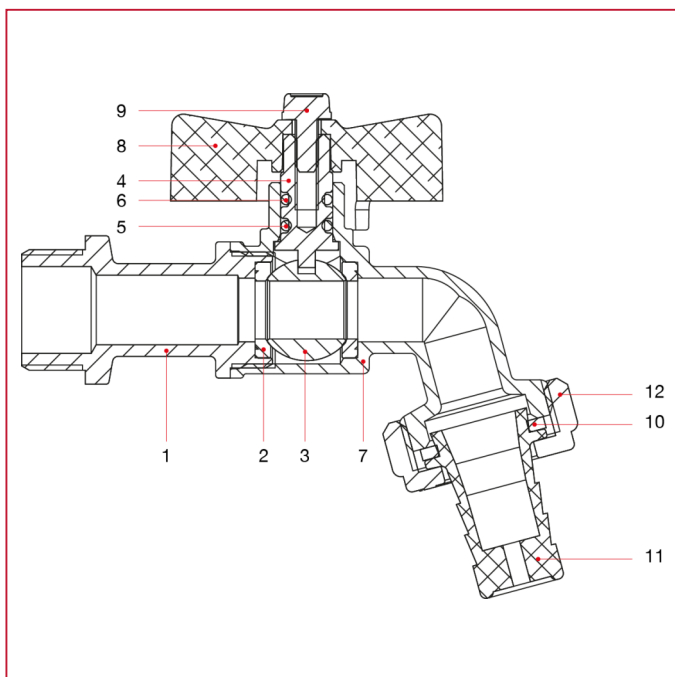

POS.	DESCRIPTION	N.	MATERIAL
1	End adapter	1	Nickel-plated brass CW617N
2	Seat	2	P.T.F.E.
3	Ball	1	Chrome-plated brass CW614N
4	Stem	1	Brass CW614N
5	O-ring	1	NBR
6	O-ring	1	Viton®
7	Body	1	Nickel-plated brass CW617N
8	T handle	1	Varnished aluminium
9	Screw	1	Zinc-plated steel C4C
10	Washer	1	NBR
11	Hose connection	1	Polymer
12	Nut	1	Nylon



BIBCOCKS

178 GAR ball hose bibcock

Available sizes: 1/2"x3/4", 3/4"x3/4"



SIZE	PRESSURE	CODE	PACKING
1/2" (DN 15)	15bar/217.5psi	1780012	20/120
3/4" (DN 20)	15bar/217.5psi	1780034	12/144

CERTIFICATIONS



TECHNICAL SPECIFICATIONS

Body in nickel-plated brass.

Lever handle in steel or T handle in aluminium.

Minimum and maximum working temperatures: -20°C, 80°C.

Threads: ISO 228 (equivalent to DIN EN ISO 228 and BS EN ISO 228).

Available also with NPT thread in the size 1/2"



BIBCOCKS

OVERALL DIMENSIONS

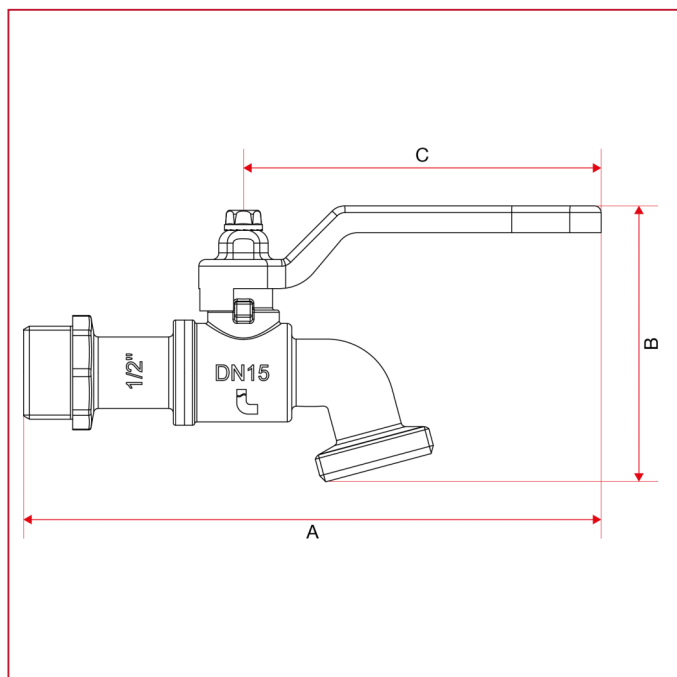

	1/2"	3/4"
DN	15	20
A	129	129
B	62	62
C	80	80
Kg/cm2 bar	15	15
LBS - psi	217,5	217,5



MATERIALS

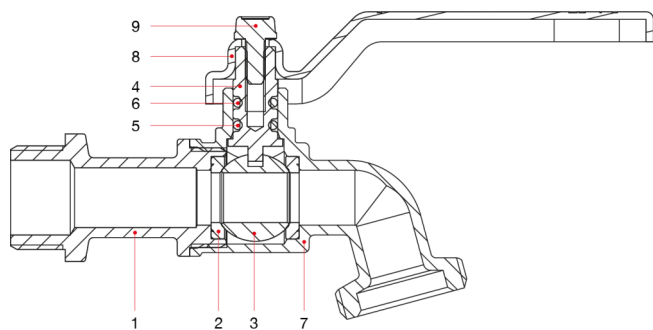

POS.	DESCRIPTION	N.	MATERIAL
1	End adapter	1	Nickel-plated brass CW617N
2	Seat	2	P.T.F.E.
3	Ball	1	Chrome-plated brass CW614N
4	Stem	1	Brass CW614N
5	O-ring	1	NBR
6	O-ring	1	Viton®
7	Body	1	Nickel-plated brass CW617N
8	Lever handle	1	Varnished steel P04
9	Screw	1	Zinc-plated steel C4C



BIBCOCKS

180 GAR ball hose bibcock

Available sizes: 1/2"x3/4"



SIZE	PRESSURE	CODE	PACKING
1/2" (DN 15)	15bar/217.5psi	1800012	20/160

CERTIFICATIONS



TECHNICAL SPECIFICATIONS

Body in nickel-plated brass.

Lever handle in steel or T handle in aluminium.

Minimum and maximum working temperatures: -20°C, 80°C.

Threads: ISO 228 (equivalent to DIN EN ISO 228 and BS EN ISO 228).

Available also with NPT thread in the size 1/2"



BIBCOCKS

OVERALL DIMENSIONS

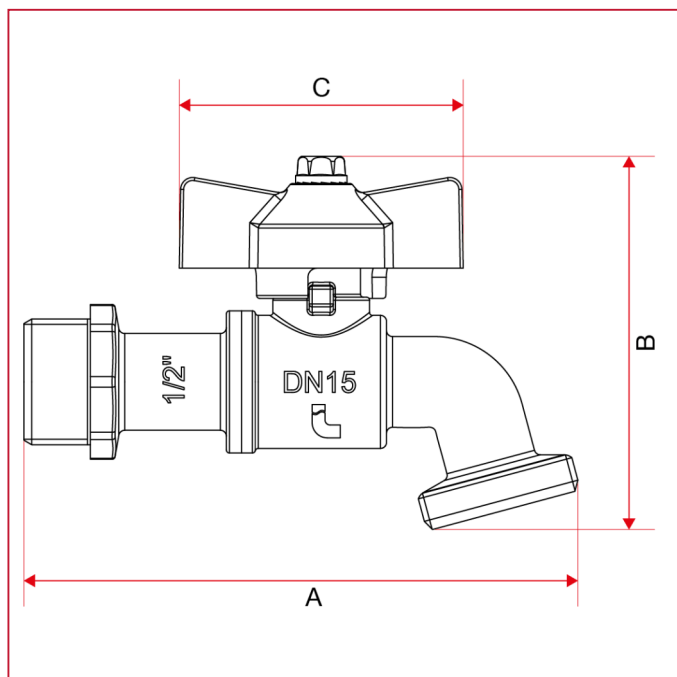

	1/2"
DN	15
A	92
B	62
C	47
Kg/cm2 bar	15
LBS - psi	217,5



MATERIALS

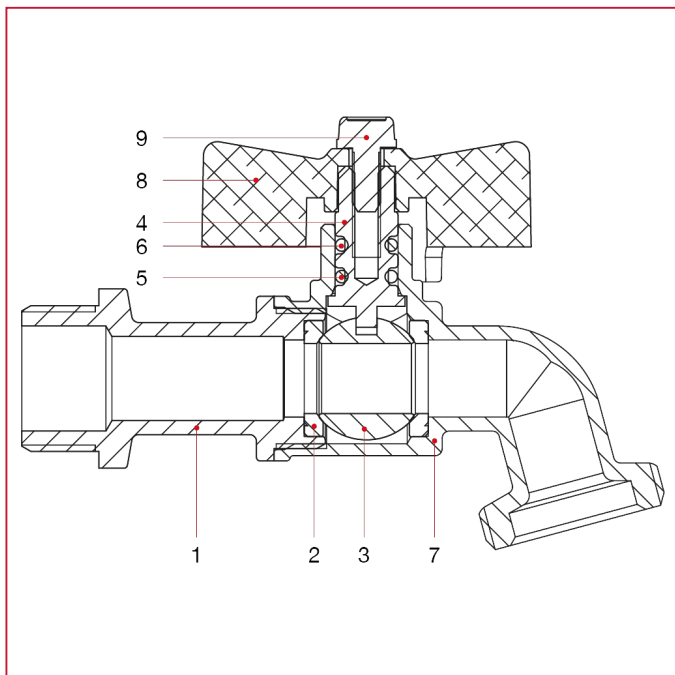

POS.	DESCRIPTION	N.	MATERIAL
1	End adapter	1	Nickel-plated brass CW617N
2	Seat	2	P.T.F.E.
3	Ball	1	Chrome-plated brass CW614N
4	Stem	1	Brass CW614N
5	O-ring	1	NBR
6	O-ring	1	Viton®
7	Body	1	Nickel-plated brass CW617N
8	T handle	1	Varnished aluminium
9	Screw	1	Zinc-plated steel C4C



BIBCOCKS

170 GAR ball bibcock



SIZE	PRESSURE	CODE	PACKING
1/2" (DN 15)	15bar/217.5psi	1700012	15/120
3/4" (DN 20)	15bar/217.5psi	1700034	10/130

CERTIFICATIONS



TECHNICAL SPECIFICATIONS

Body in nickel-plated brass.

Lever handle in steel or T handle in aluminium.

Minimum and maximum working temperatures: -20°C, 80°C.

Threads: ISO 228 (equivalent to DIN EN ISO 228 and BS EN ISO 228).



BIBCOCKS

OVERALL DIMENSIONS

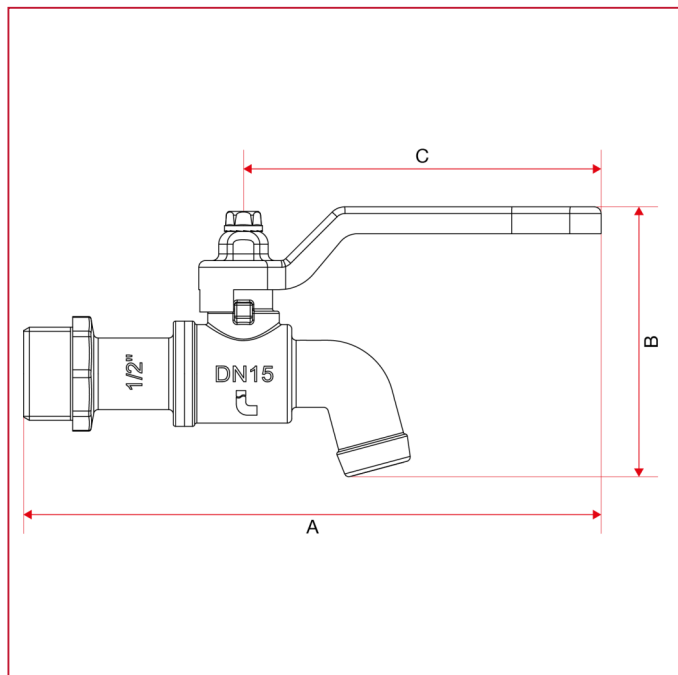

	1/2"	3/4"
DN	15	20
A	129	131,5
B	60	65,5
C	80	80
Kg/cm2 bar	15	15
LBS - psi	217,5	217,5



MATERIALS

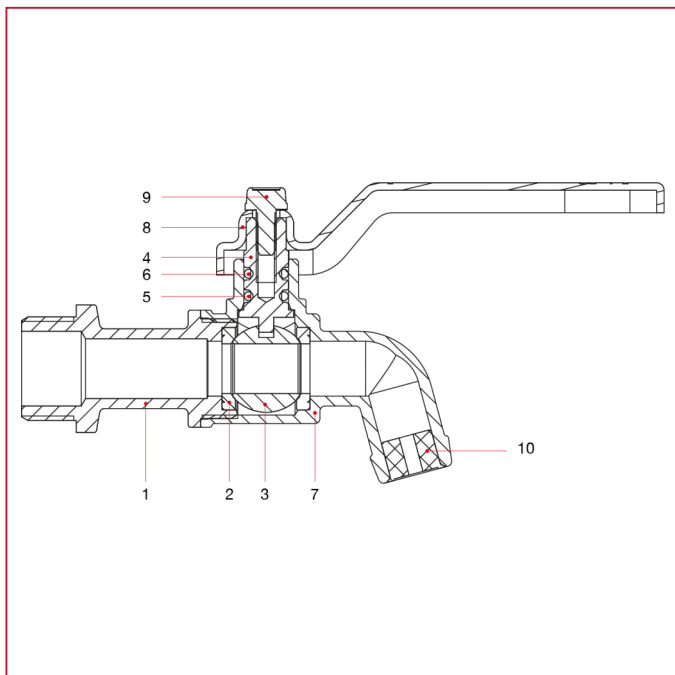

POS.	DESCRIPTION	N.	MATERIAL
1	End adapter	1	Nickel-plated brass CW617N
2	Seat	2	P.T.F.E.
3	Ball	1	Chrome-plated brass CW614N
4	Stem	1	Brass CW614N
5	O-ring	1	NBR
6	O-ring	1	Viton®
7	Body	1	Nickel-plated brass CW617N
8	Lever handle	1	Varnished steel P04
9	Screw	1	Zinc-plated steel C4C
10	Hose end	1	Polymer



BIBCOCKS

172 GAR ball bibcock



SIZE	PRESSURE	CODE	PACKING
1/2" (DN 15)	15bar/217.5psi	1720012	15/120
3/4" (DN 20)	15bar/217.5psi	1720034	10/130

CERTIFICATIONS



TECHNICAL SPECIFICATIONS

Body in nickel-plated brass.

Lever handle in steel or T handle in aluminium.

Minimum and maximum working temperatures: -20°C, 80°C.

Threads: ISO 228 (equivalent to DIN EN ISO 228 and BS EN ISO 228).



BIBCOCKS

OVERALL DIMENSIONS

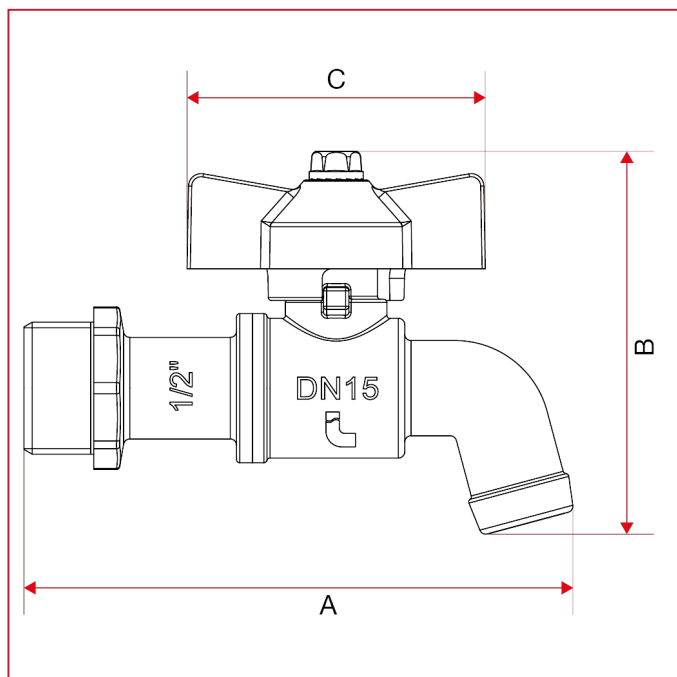

	1/2"	3/4"
DN	15	20
A	86,5	93,5
B	60	65
C	47	47
Kg/cm2 bar	15	15
LBS - psi	217,5	217,5



MATERIALS

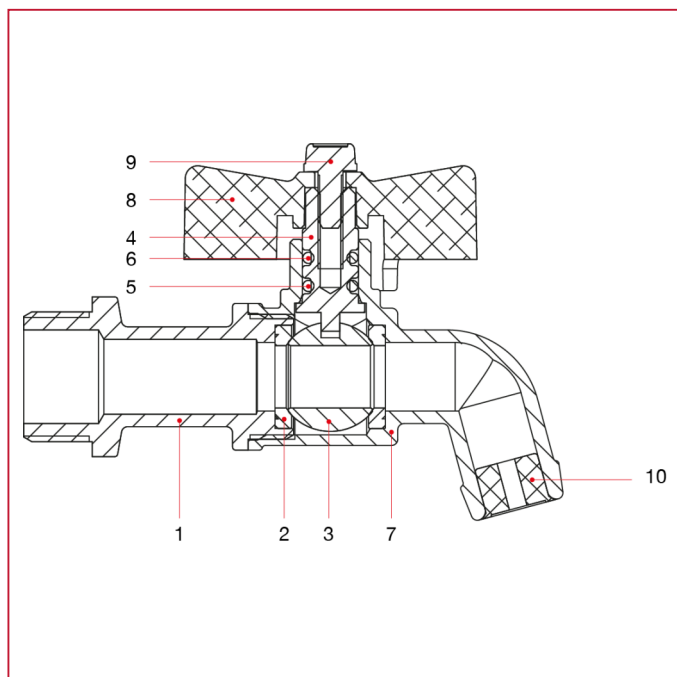

POS.	DESCRIPTION	N.	MATERIAL
1	End adapter	1	Nickel-plated brass CW617N
2	Seat	2	P.T.F.E.
3	Ball	1	Chrome-plated brass CW614N
4	Stem	1	Brass CW614N
5	O-ring	1	NBR
6	O-ring	1	Viton®
7	Body	1	Nickel-plated brass CW617N
8	T handle	1	Varnished aluminium
9	Screw	1	Zinc-plated steel C4C
10	Hose end	1	Polymer



BIBCOCKS

144 Ball hose bibcock with lockpad eye

Available sizes: 1/2"x3/4", 3/4"x3/4"



SIZE	PRESSURE	CODE	PACKING
1/2" (DN 15)	15bar/217.5psi	1440012	8/64
3/4" (DN 20)	15bar/217.5psi	1440034	8/64

CERTIFICATIONS



TECHNICAL SPECIFICATIONS

Body in nickel-plated brass.

Hose connection in brass.

Lever handle in steel.

Minimum and maximum working temperatures: 0°C, 80°C.

Threads: ISO228 (equivalent to DIN EN ISO 228 and BS EN ISO 228).



BIBCOCKS

OVERALL DIMENSIONS

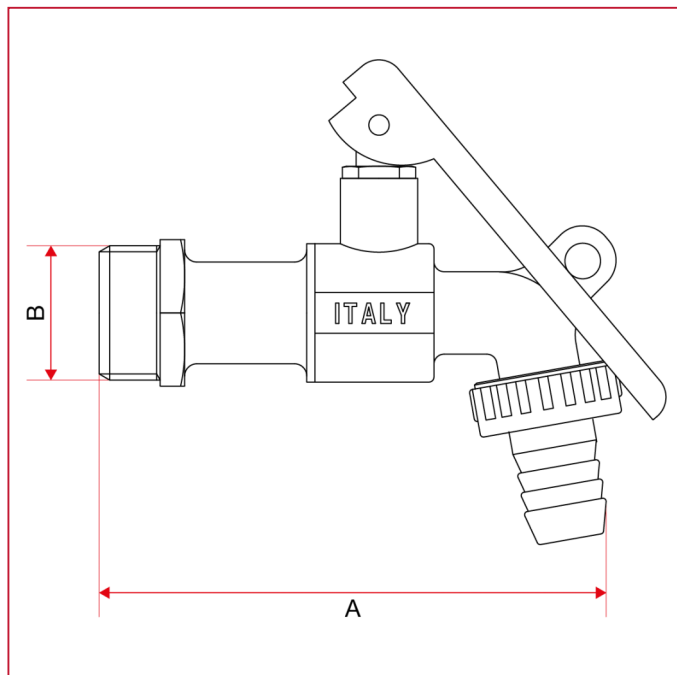

	1/2"	3/4"
A	102	102
B	1/2"	3/4"
Kg/cm ² bar	15	15
LBS - psi	217,5	217,5



MATERIALS

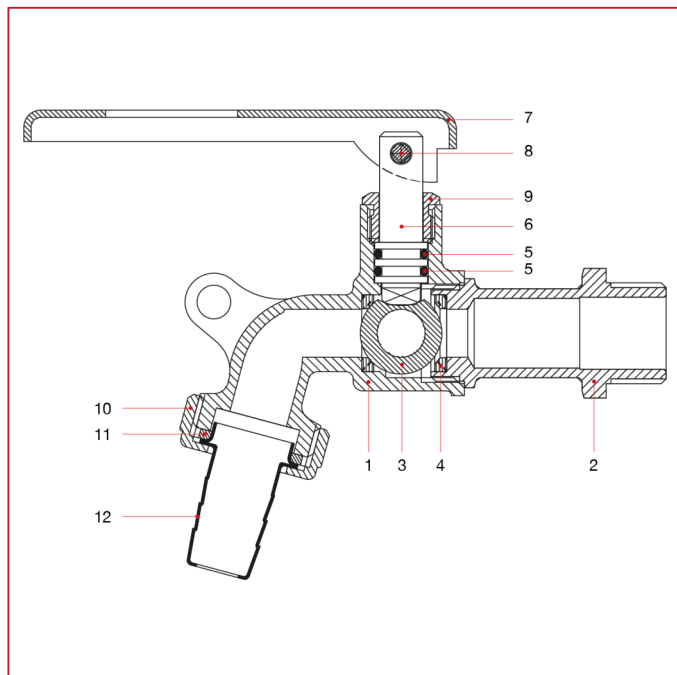

POS.	DESCRIPTION	N.	MATERIAL
1	Body	1	Nickel-plated brass CW617N
2	End adapter	1	Nickel-plated brass CW617N
3	Ball	1	Chrome-plated brass CW614N
4	Seal	2	P.T.F.E.
5	O-ring	1	NBR
6	Stem	1	Brass CW614N
7	Nut	1	Brass CW614N
8	Lever handle	1	Steel
9	Handle pin	1	Aluminium
10	Washer	1	Rubber
11	Hose connection	1	Nickel-plated brass CW617N
12	Nut	1	Nickel-plated brass CW617N



BIBCOCKS

191 Garden hose bibcock with brass connection

Available sizes: 1/2"x3/4", 3/4"x1", 1"x1"1/4



SIZE	PRESSURE	CODE	PACKING
1/2" (DN 15)	15bar/217.5psi	1910012	12/48
3/4" (DN 20)	15bar/217.5psi	1910034	10/40
1" (DN 25)	12bar/174psi	1910100	5/40

CERTIFICATIONS

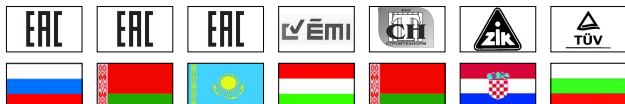

TECHNICAL SPECIFICATIONS

Body in brass.

Hose connection in brass.

T handle in aluminium.

Minimum and maximum working temperatures: 0°C, 80°C.

Threads: ISO228 (equivalent to DIN EN ISO 228 and BS EN ISO 228).



BIBCOCKS

OVERALL DIMENSIONS

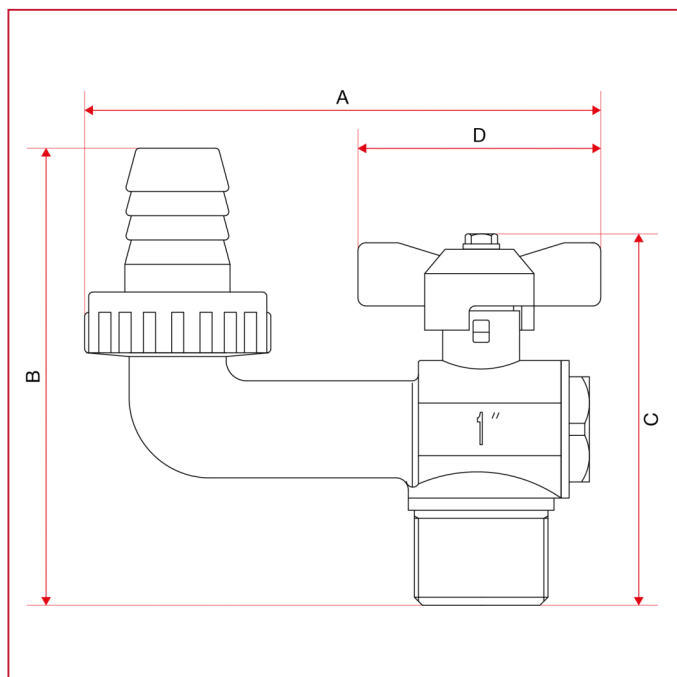

	1/2"	3/4"	1"
A	101	111	126
B	81	92	111
C	74	79	91
D	61	61	61
Kg/cm ² bar	15	15	12
LBS - psi	217,5	217,5	174



MATERIALS

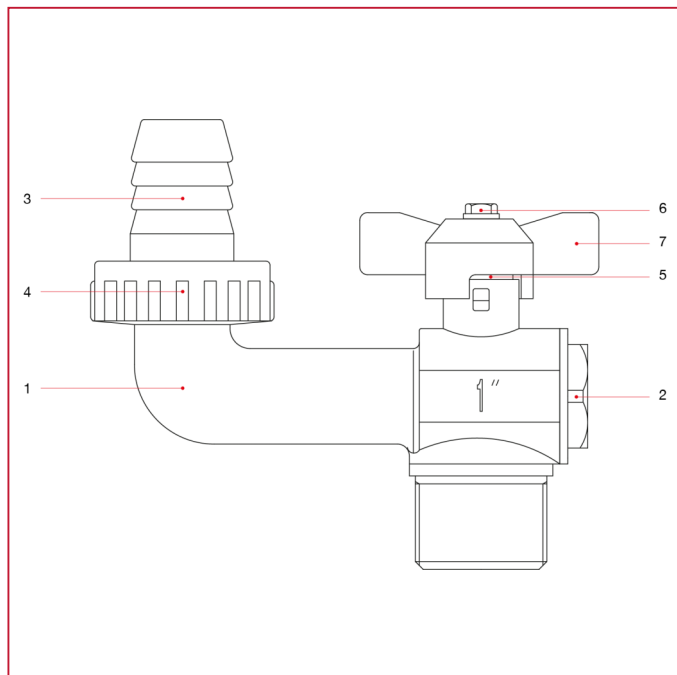

POS.	DESCRIPTION	N.	MATERIAL
1	Body	1	Brass CW617N
2	Cap	1	Brass CW617N
3	Hose connection	1	Brass CW614N
4	Nut	1	Brass CW614N
5	Packing gland	1	Brass CW614N
6	Screw	1	Zinc-plated steel C4C
7	T handle	1	Varnished aluminium



BIBCOCKS

139 Drain ball valve with brass hose connection



SIZE	PRESSURE	CODE	PACKING
3/8" (DN 10)	12bar/174psi	1390038	20/200
1/2" (DN 15)	12bar/174psi	1390012	20/200
3/4" (DN 20)	12bar/174psi	1390034	15/120

CERTIFICATIONS



TECHNICAL SPECIFICATIONS

Body in brass.

Hose connection in brass.

Minimum and maximum working temperatures:

-15°C, 110°C with air; 0°C, 90°C with water.

Threads: ISO228 (equivalent to DIN EN ISO 228 and BS EN ISO 228).



BIBCOCKS

OVERALL DIMENSIONS

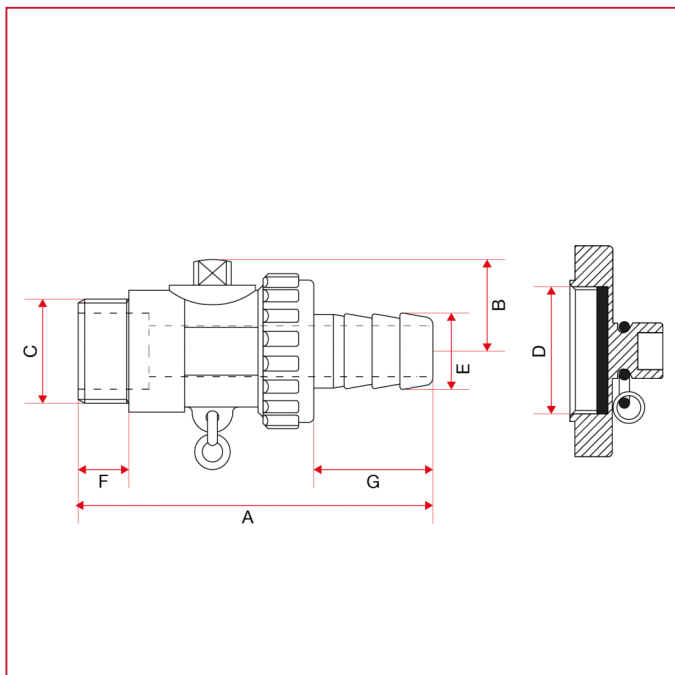

	3/8"	1/2"	3/4"
DN	10	15	20
A	71,5	71,5	86
B	18	18	22
C	3/8"	1/2"	3/4"
D	3/4"	3/4"	1"
E	15	15	20,5
F	12	14	14
G	23	23	23
Kg/cm2 bar	12	12	12
LBS - psi	174	174	174



MATERIALS

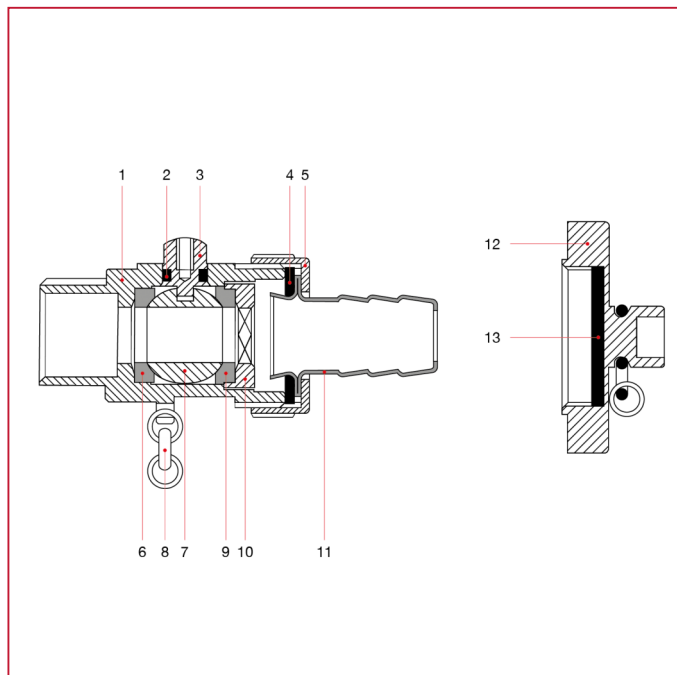

POS.	DESCRIPTION	N.	MATERIAL
1	Body	1	Brass CW617N
2	Washer	1	NBR
3	Stem	1	Brass CW617N
4	Washer	1	NBR
5	Nut	1	Brass CW617N
6	Seat	1	P.T.F.E.
7	Ball	1	Chrome-plated brass CW617N
8	Chain	1	Brass CW508L
9	Seat	1	P.T.F.E.
10	Washer	1	Brass CW617N
11	Hose connection	1	Brass CW508L
12	Cap	1	Brass CW508L
13	Washer	1	NBR



BIBCOCKS

139R Drain ball valve with brass hose connection and nylon handle



SIZE	PRESSURE	CODE	PACKING
3/8" (DN 10)	10bar/145psi	1390038R	20/260
1/2" (DN 15)	10bar/145psi	1390012R	20/260
3/4" (DN 20)	10bar/145psi	1390034R	15/120

CERTIFICATIONS



TECHNICAL SPECIFICATIONS

Body in brass.

Hose connection in brass.

Minimum and maximum working temperatures: -10°C, 90°C.

Threads: ISO228 (equivalent to DIN EN ISO 228 and BS EN ISO 228).



BIBCOCKS

OVERALL DIMENSIONS

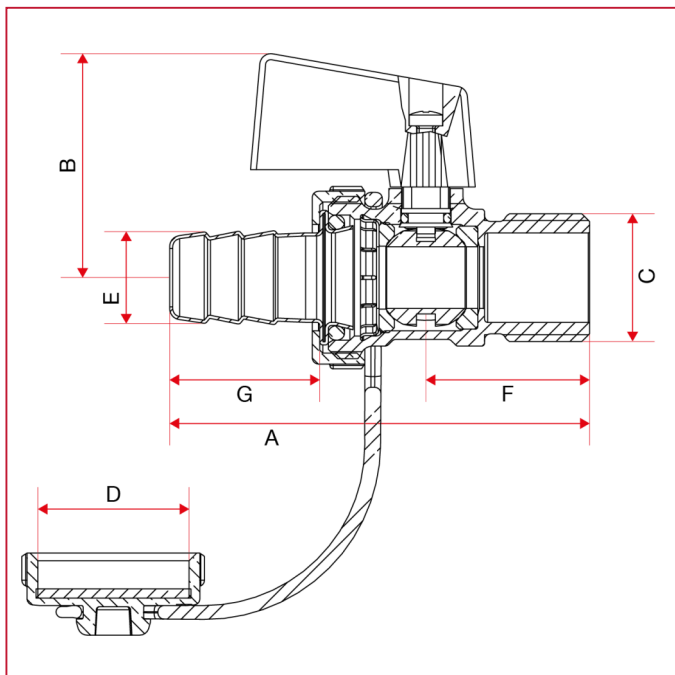

	3/8"	1/2"	3/4"
DN	10	15	20
A	62,2	68	67,09999 99999999 9
B	36,3	36,3	-
C	3/8"	1/2"	3/4"
D	3/4"	3/4"	3/4"
E	15	15	15
F	20,7	26,5	23,7
G	24,3	24,3	24,3
Kg/cm2 bar	10	10	10
LBS - psi	145	145	145



MATERIALS

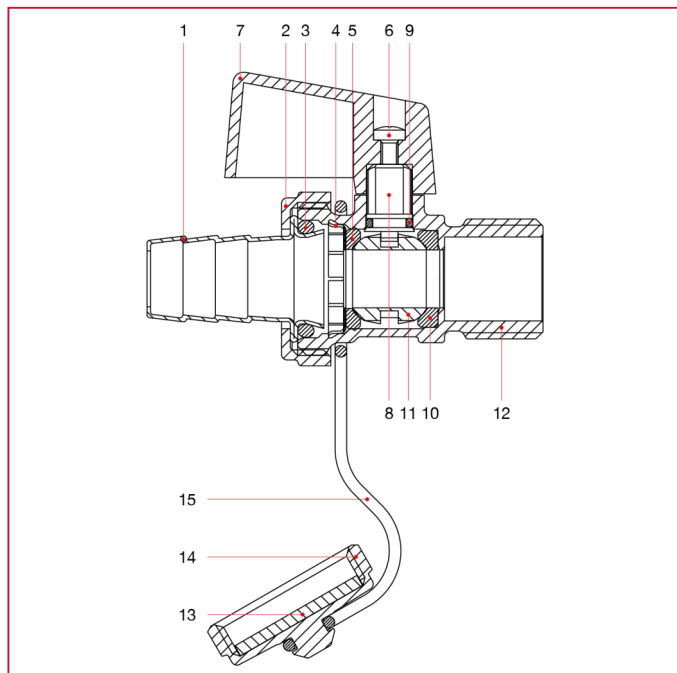

POS.	DESCRIPTION	N.	MATERIAL
1	Hose connection	1	Brass CW508L
2	Nut	1	Brass CW617N
3	O-ring	1	NBR
4	Sleeve	1	Brass CW617N
5	Seat	1	P.T.F.E.
6	Screw	1	Zinc-plated steel
7	Handle	1	Nylon 66
8	Stem	1	Brass CW617N
9	O-ring	1	NBR
10	Seat	1	P.T.F.E.
11	Ball	1	Brass CW617N
12	Body	1	Brass CW617N
13	Washer	1	EPDM
14	Cap	1	Brass CW617N
15	Strap	1	Elastomero



BIBCOCKS

280 Brass hose connection



SIZE	CODE	PACKING
3/4" (DN 20)	2800034	100/1200
1" (DN 25)	2800100	50/600
1"1/4 (DN 32)	2800114	25/300

TECHNICAL SPECIFICATIONS

Hose connection in nickel-plated brass.

Min. and max. working temperatures: -20°C, 80°C.

Threads: ISO228 (equivalent to DIN EN ISO 228 and BS EN ISO 228).

OVERALL DIMENSIONS

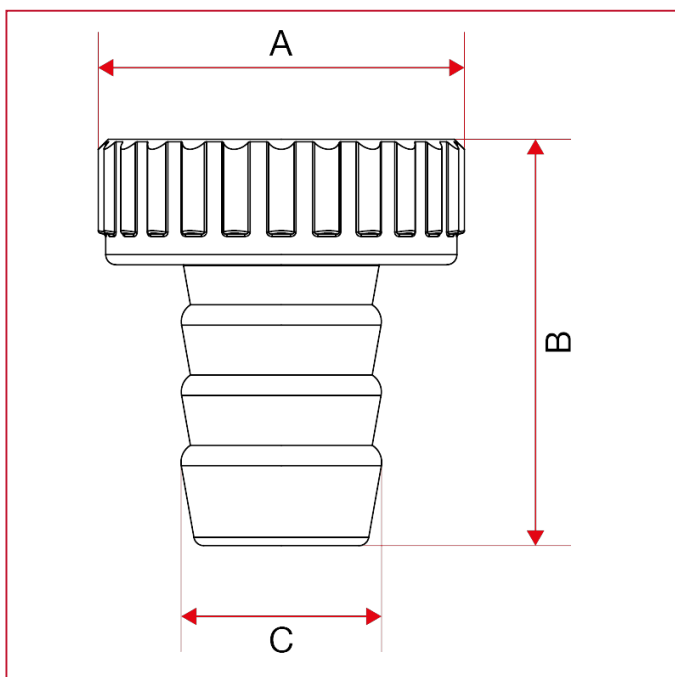

	3/4"	1"	1"1/4
DN	20	25	32
A	30	36,5	46
B	33,5	40,5	49,7
C	14,5	20	26



BIBCOCKS

MATERIALS

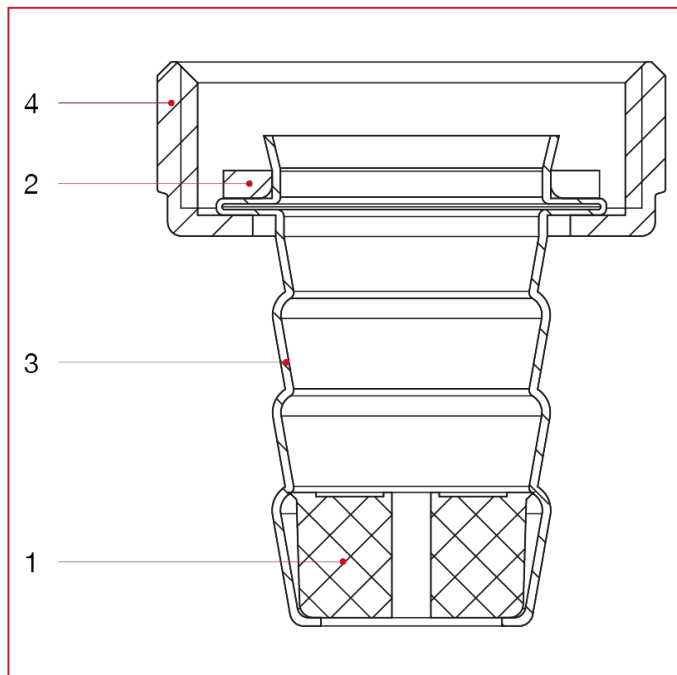

POS.	DESCRIPTION	N.	MATERIAL
1	Hose end	1	Polymer
2	Washer	1	Elastomer
3	Hose connection	1	Nickel-plated brass CW508L
4	Nut	1	Nickel-plated brass CW617N



BIBCOCKS

282 Nylon hose connection



SIZE	CODE	PACKING
3/4" (DN 20)	2820034	150/1800
1" (DN 25)	2820100	75/900

TECHNICAL SPECIFICATIONS

Hose connection in nylon.

Min. and max. working temperatures: -20°C, 80°C.

Threads: ISO228 (equivalent to DIN EN ISO 228 and BS EN ISO 228).

OVERALL DIMENSIONS

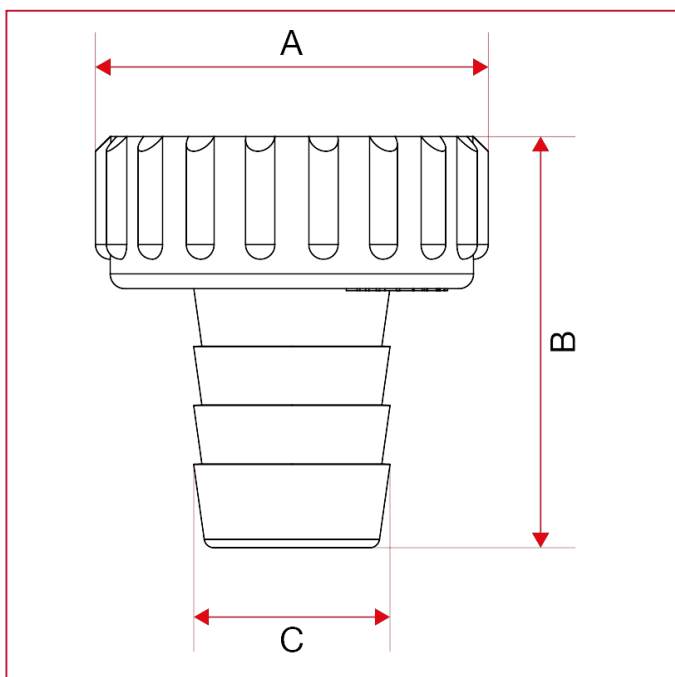

	3/4"	1"
DN	20	25
A	33	40
B	33,5	42
C	14,8	20



BIBCOCKS

MATERIALS

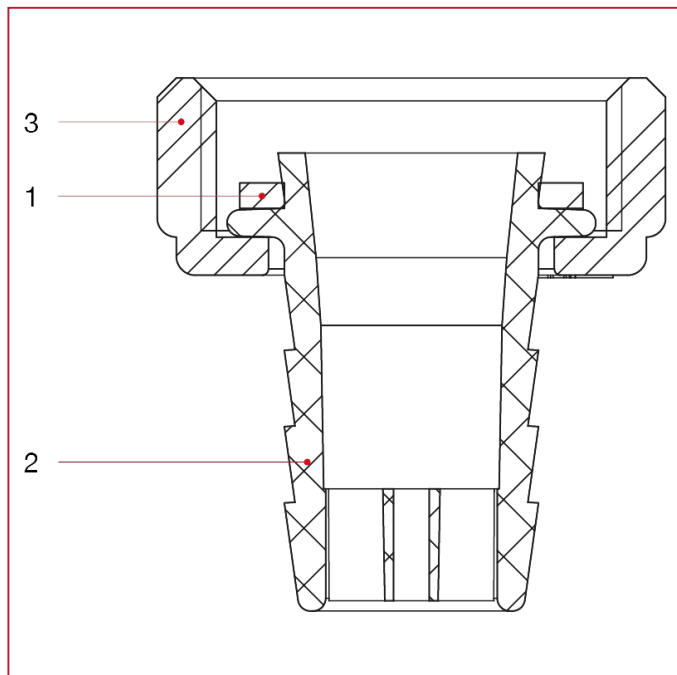

POS.	DESCRIPTION	N.	MATERIAL
1	Washer	1	NBR
2	Hose connection	1	Polymer
3	Nut	1	Nylon



BIBCOCKS

2820 Mobile hose connection in nylon



SIZE	CODE	PACKING
3/4" (DN 20)	28200340	50/600

TECHNICAL SPECIFICATIONS

Minimum and maximum working temperatures: -20°C, 80°C.

Threads: ISO 228 (equivalent to DIN EN ISO 228 and BS EN ISO 228).

OVERALL DIMENSIONS

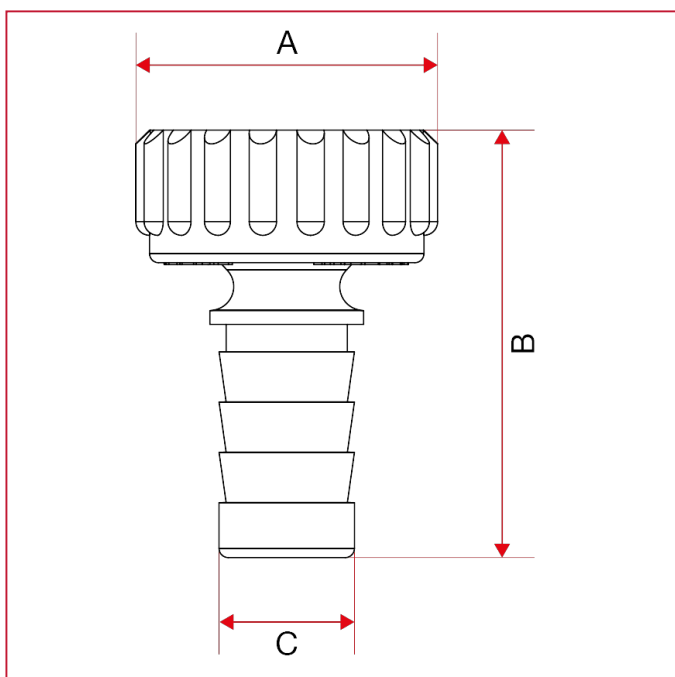

	3/4"
DN	20
A	33
B	47
C	14,8



BIBCOCKS

MATERIALS

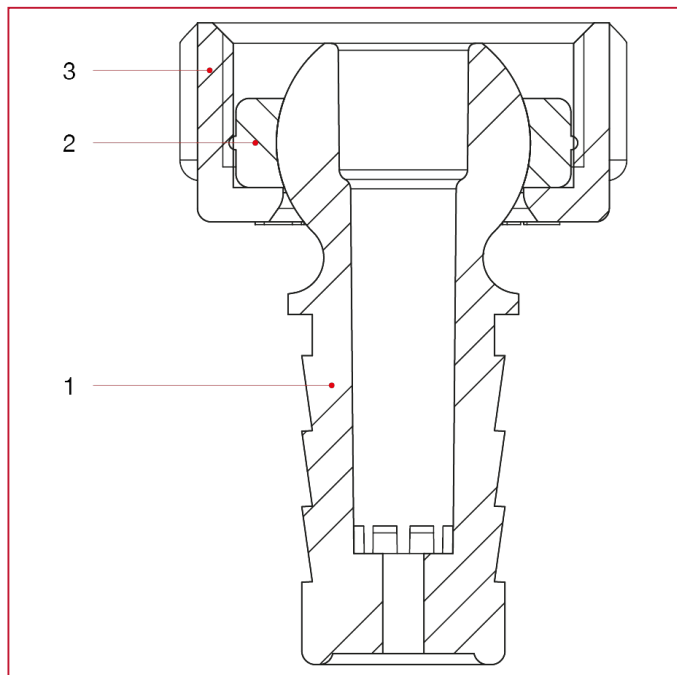

POS.	DESCRIPTION	N.	MATERIAL
1	Hose connection	1	Nylon
2	Nut	1	Nylon
3	Washer	1	NBR



BIBCOCKS

350L Supply bibcock



SIZE	PRESSURE	CODE	PACKING
1/2" (DN 15)	8bar/116psi	3500012L	10/100

CERTIFICATIONS



TECHNICAL SPECIFICATIONS

Body in polished brass.

T handle in brass.

Minimum and maximum working temperatures: 0°C, 80°C.

Threads: ISO228 (equivalent to DIN EN ISO 228 and BS EN ISO 228).



BIBCOCKS

OVERALL DIMENSIONS

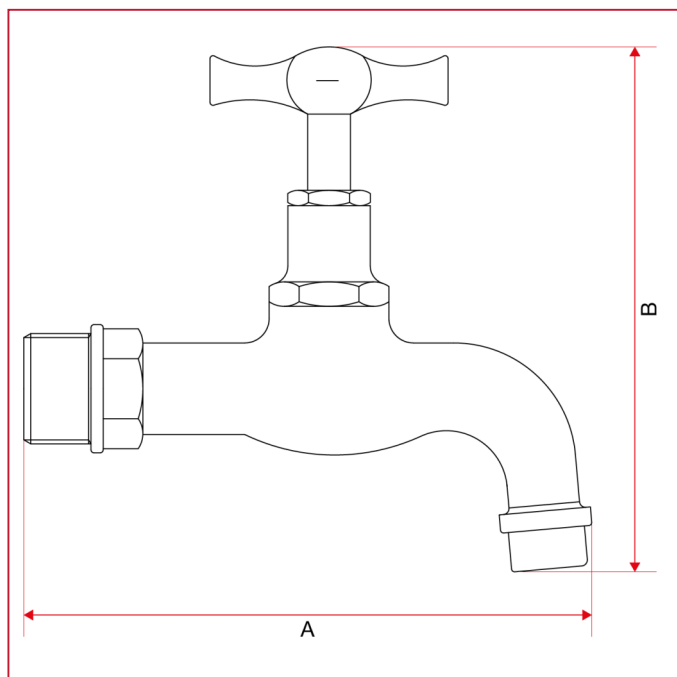

	1/2"
A	115
B	105
Kg/cm2 bar	8
LBS - psi	116



BIBCOCKS

MATERIALS

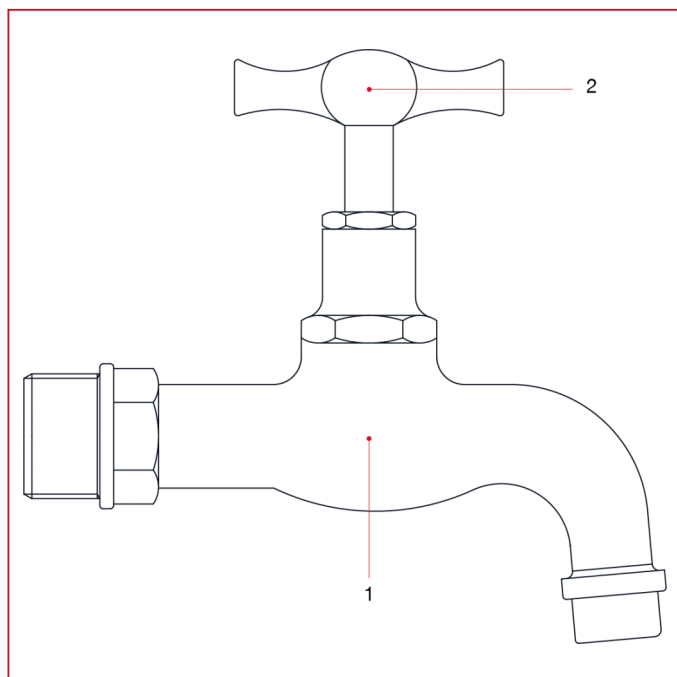

POS.	DESCRIPTION	N.	MATERIAL
1	Body	1	Brass CB753S
2	Handle	1	Brass CW614N
-	O-ring	-	NBR



BIBCOCKS

355L Hose bibcock



SIZE	PRESSURE	CODE	PACKING
1/2" (DN 15)	8bar/116psi	3550012L	10/70
3/4" (DN 20)	8bar/116psi	3550034L	5/50

CERTIFICATIONS



TECHNICAL SPECIFICATIONS

Body in polished brass.

Hose connection in brass.

T handle in brass.

Minimum and maximum working temperatures: 0°C, 80°C.

Threads: ISO228 (equivalent to DIN EN ISO 228 and BS EN ISO 228).



BIBCOCKS

OVERALL DIMENSIONS

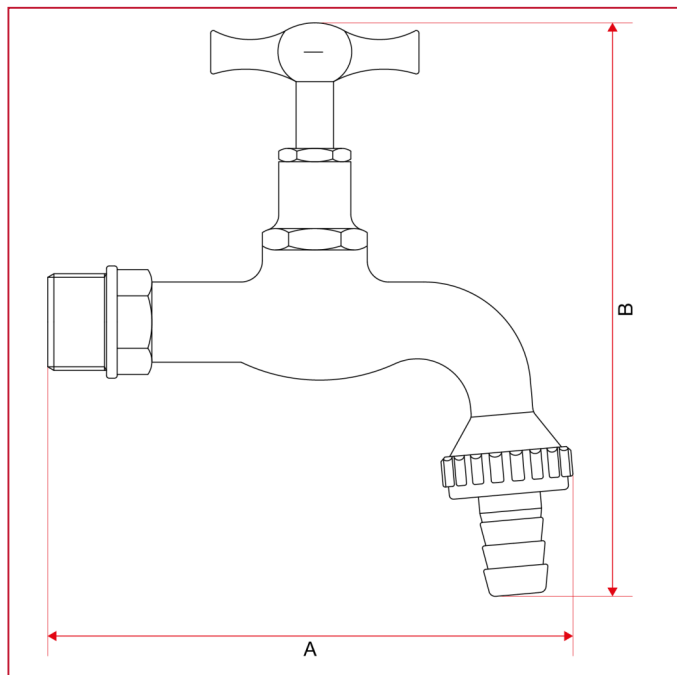

	1/2"	3/4"
A	122	128
B	133	145
Kg/cm ² bar	8	8
LBS - psi	116	116



BIBCOCKS

MATERIALS

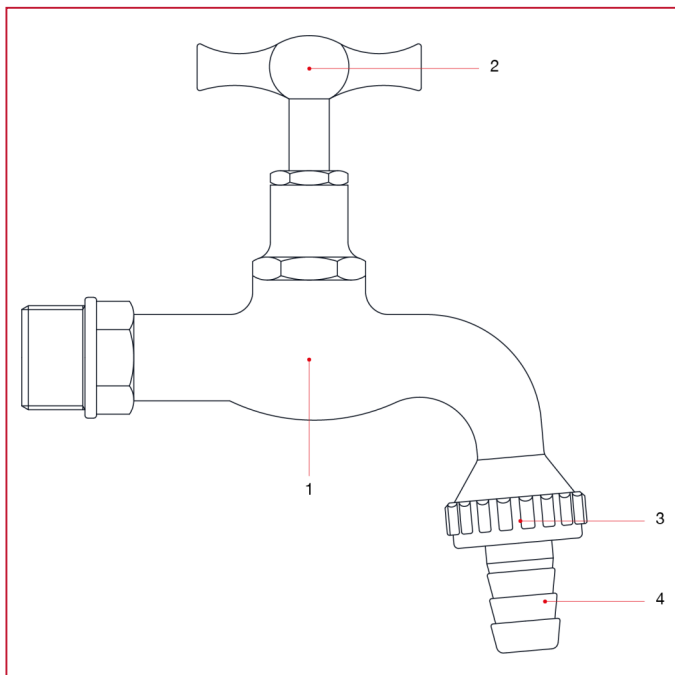

POS.	DESCRIPTION	N.	MATERIAL
1	Body	1	Brass CW617N
2	Handle	1	Brass CW614N
3	Nut	1	Brass CW617N
4	Hose connection	1	Brass CW614N
-	Washer	1	PVC
-	O-ring	-	NBR



BIBCOCKS

355S Hose bibcock



SIZE	PRESSURE	CODE	PACKING
1/2" (DN 15)	8bar/116psi	3550012S	10/70
3/4" (DN 20)	8bar/116psi	3550034S	5/50

CERTIFICATIONS



TECHNICAL SPECIFICATIONS

Body in sandblasted/chromed brass.

Hose connection in chromed brass.

T handle in chromed brass.

Minimum and maximum working temperatures: 0°C, 80°C.

Threads: ISO228 (equivalent to DIN EN ISO 228 and BS EN ISO 228).



BIBCOCKS

OVERALL DIMENSIONS

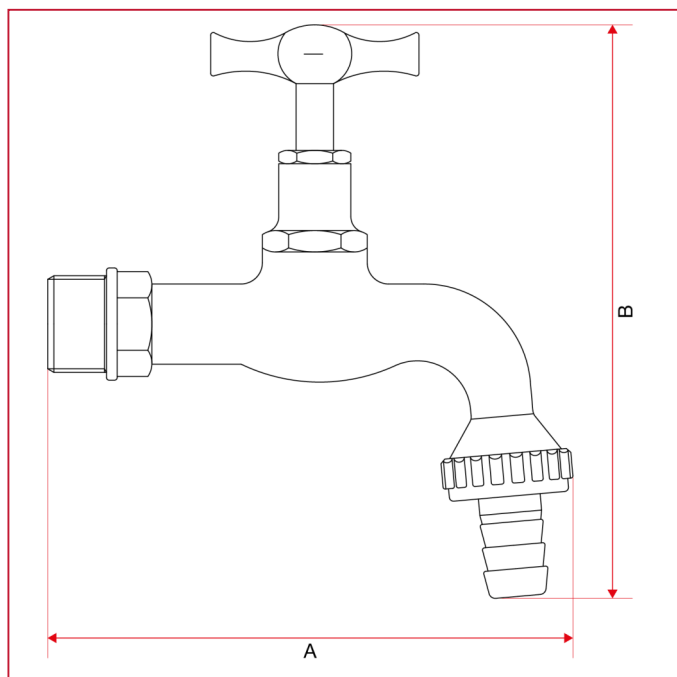

	1/2"	3/4"
A	122	128
B	133	145
Kg/cm ² bar	8	8
LBS - psi	116	116



BIBCOCKS

MATERIALS

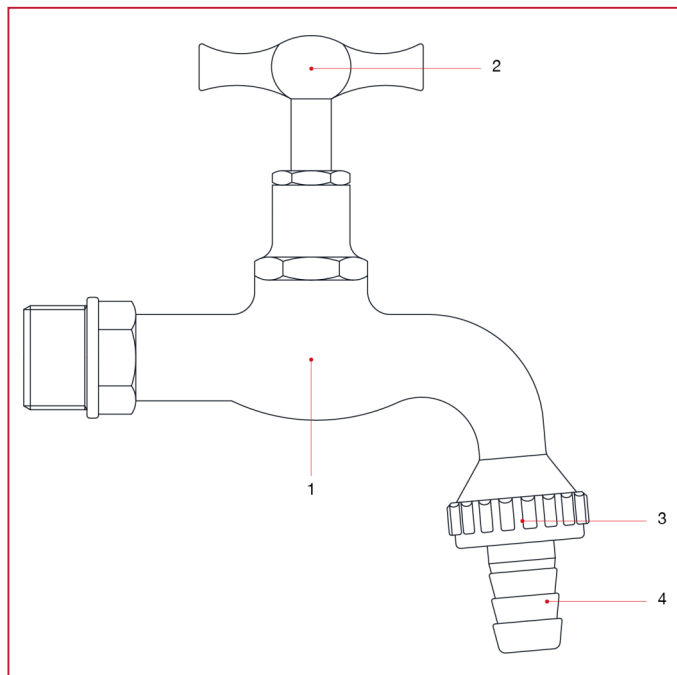

POS.	DESCRIPTION	N.	MATERIAL
1	Body	1	Sandblasted and chrome-plated brass CB753S
2	Handle	1	Chrome-plated brass CW614N
3	Nut	1	Chrome-plated brass CW617N
4	Hose connection	1	Chrome-plated brass CW508L
-	Washer	1	PVC
-	O-ring	-	NBR



ITAP S.p.A.
Via Ruca 19
25065 Lumezzane
Brescia (ITALY)
Tel 030 8927011
Fax 030 8921990
www.itap.it - info@itap.it

We reserve the right to make improvements
and changes to the products described
herein and to the relative technical data, at
any time and without forewarning.

rev. 20210301