

STAINLESS STEEL FITTINGS PIPE NIPPLE AND SOCKET BSP CLASS 150 PN20

SPECIFICATIONS :

- Male conical ends threaded BSP
- Female cylindrical ends threaded BSP
- Socket and half-socket fittings made from seamless pipe
- Pipe and barrel nipple made from welded pipe

USE :

- For all common fluids of 2nd group
- Min Temperature Ts : - 25°C
- Max Temperature Ts :+ 180°C
- Max Pressure Ps : 20 bars

RANGE :

- From DN1/8" to DN4"
- Stainless steel ASTM A351 CF8M fittings excepted for types Ref.2034, 2038, 2039, 2040, 2041and 2042 in ASTM A182 F316

SIZE (in mm) :

- **Socket bright F. F. (DN 1/8"– 4") Ref. 2015**

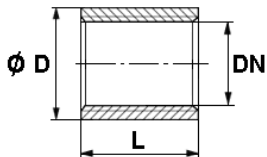

DN	1/8"	1/4"	3/8"	1/2"	3/4"	1"	1"1/4"	1"1/2"	2"	2"1/2"	3"	4"
Ø D	15	18.5	21.3	26.6	31.8	39.5	48.3	54.5	66.3	82	95	122
L	17	25	26	34	36	43	48	48	56	65	71	83
Weig. (Kg)	0.01	0.03	0.03	0.07	0.08	0.14	0.2	0.24	0.3	0.51	0.67	1.2

- **Half socket F. F. (DN 1/8"– 2") Ref. 2017**

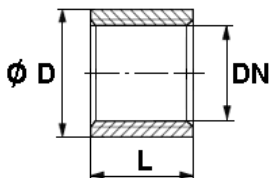

DN	1/8"	1/4"	3/8"	1/2"	3/4"	1"	1"1/4"	1"1/2"	2"
Ø D	15	18.5	21.3	26.6	31.8	39.5	48.3	54.5	66.3
L	8	11	12	15	17	19.5	22	22	26
Weig. (Kg)	0.01	0.01	0.02	0.03	0.04	0.05	0.09	0.1	0.16